

ROW TYPE 1 (PILE DIAGRAM)
SHOW PILE POSITIONS

CUMULATIVE UPRIGHT DIMENSION FROM DATUM A

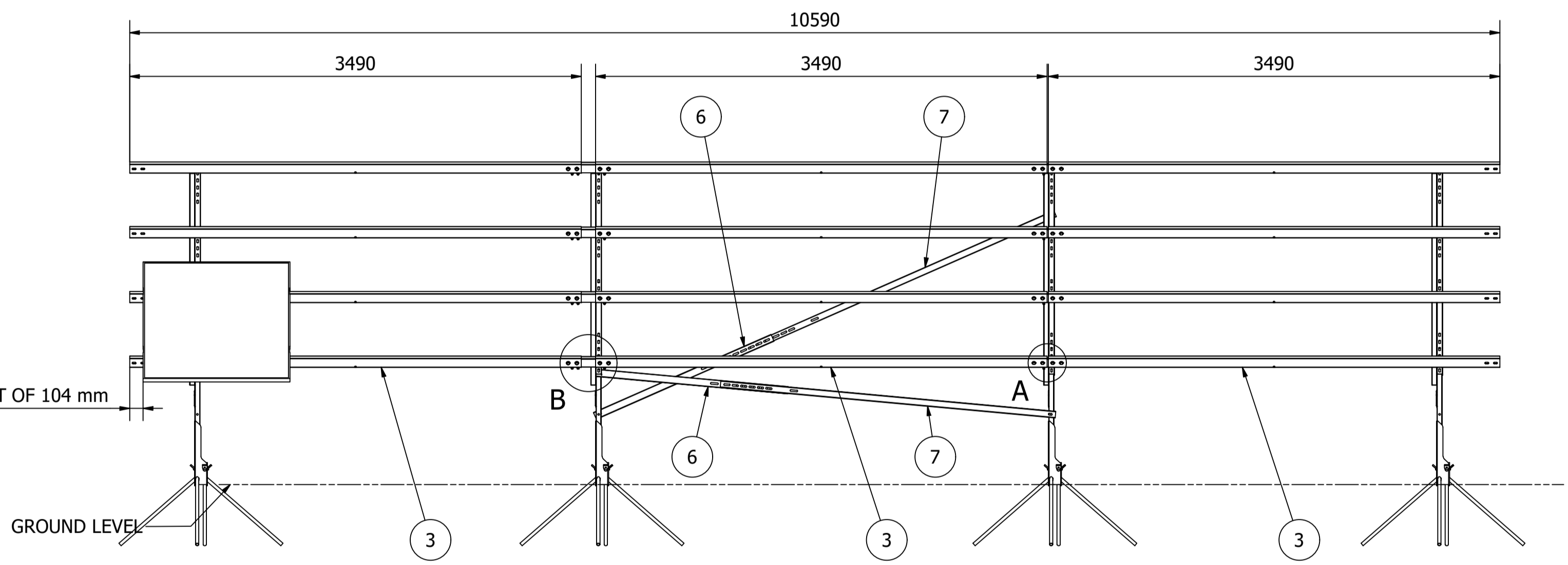

ROW TYPE 1 (PURLIN DIAGRAM)
SHOW PURLIN POSITIONS

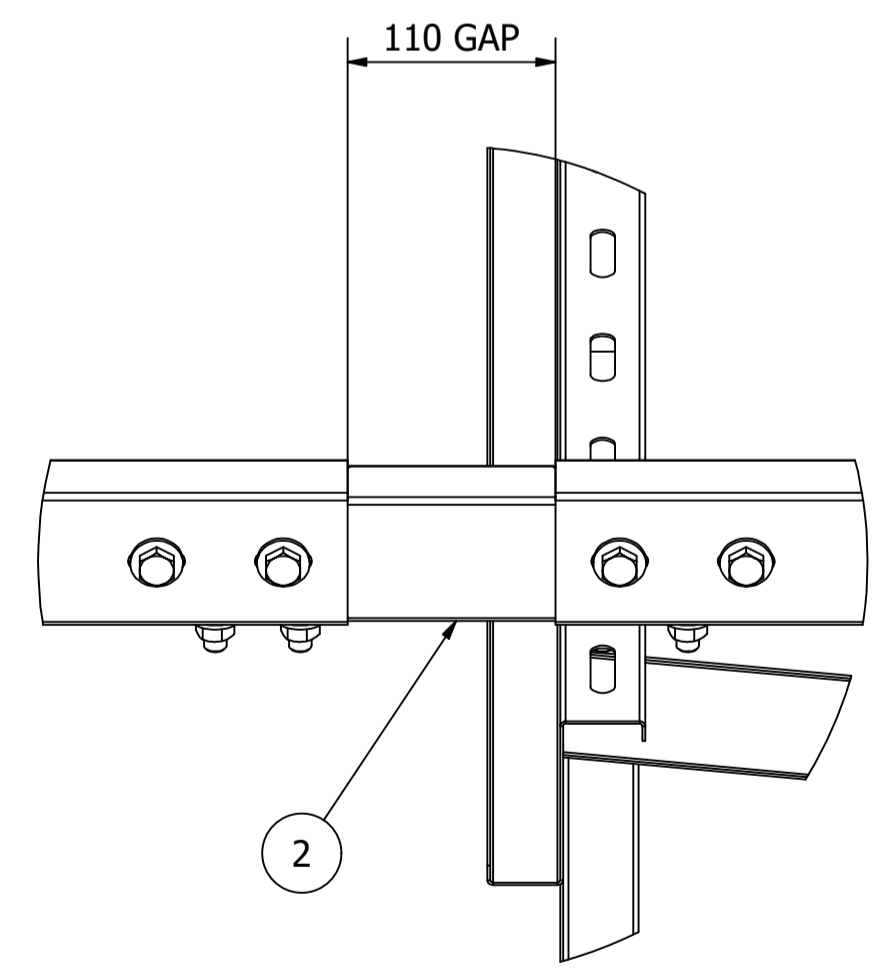

DETAIL VIEW B (1 : 4)
TYP ALL POSNS

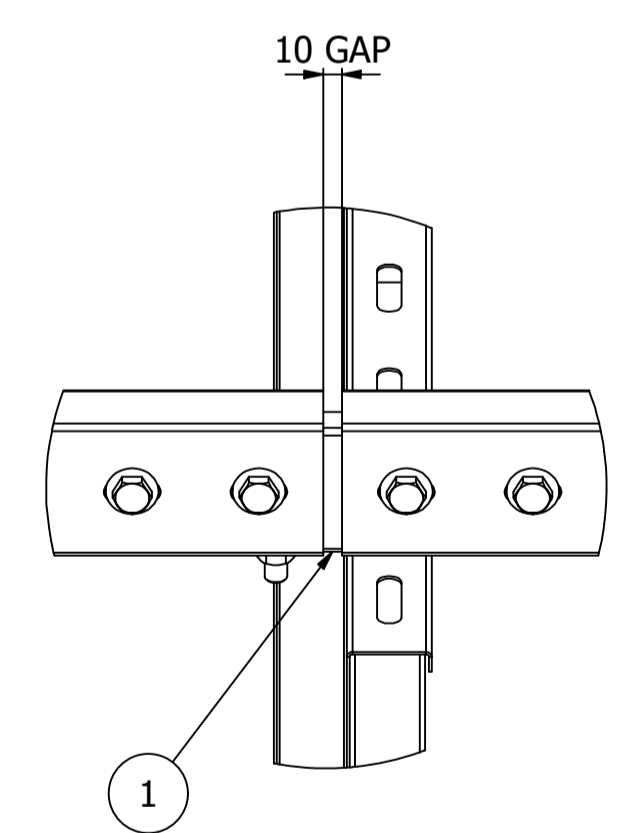

DETAIL VIEW A (1 : 4)
TYP ALL POSNS

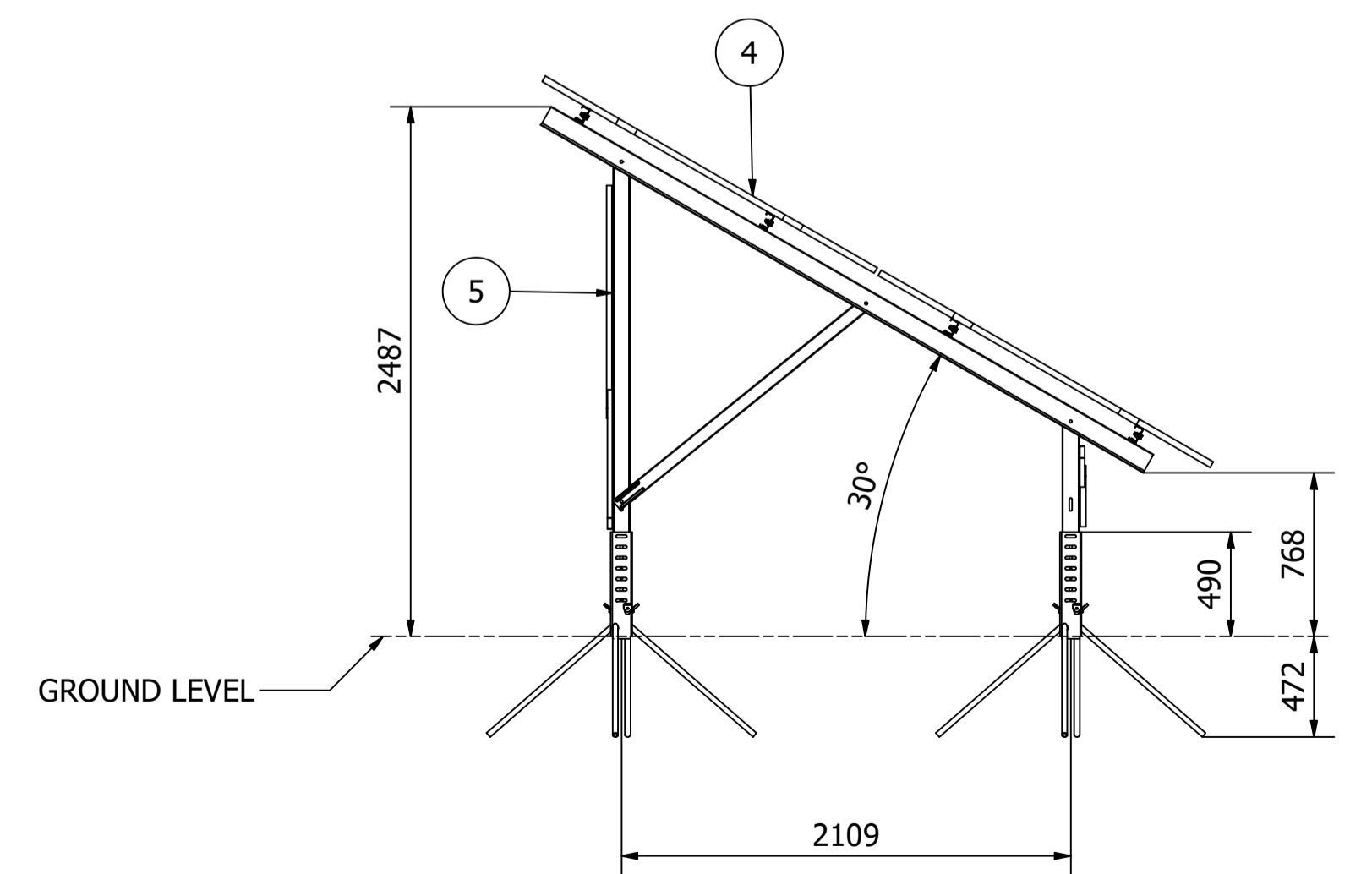

ROW TYPE 1 (SIDE VIEW)
NOT TO SCALE
SHOW UPRIGHT POSITIONS

| PARTS LIST | | | |
|------------|-----|----------------------|-------------------------------------|
| ITEM | QTY | PART NUMBER | DESCRIPTION |
| 1 | 4 | 0000-JRC-105 | GM COMMON JOINER 75x34x20x1.45 300L |
| 2 | 4 | 0000-JRC-106 | GM EXTENDER JOINER W FIXINGS |
| 3 | 12 | 1261-PUR-3490 | GM PURLIN 80x40x1.45 3490L |
| 4 | 18 | 2 In P - Solar Panel | |
| 5 | 4 | 2 in P - UPA - ADS | |
| 6 | 2 | 0000-RBR-001 | External Wind Brace 1500x57x26x1.45 |
| 7 | 2 | 0000-RBR-005 | Internal Wind Brace 2600x51x29x1.45 |

IMPORTANT NOTE:

- PANEL CLAMPING ZONE ADHERENCE IS THE RESPONSIBILITY OF INSTALLER. PURLIN POSITION CAN BE ADJUSTED TO SUIT PANEL MANUFACTURER'S CLAMPING ZONE. REFER TO THE PANEL MANUFACTURER SPECIFICATIONS FOR CLAMPING INFORMATION.
- WIND BRACING INCLUDED ON DRAWING, PLEASE REFER TO INSTALLATION GUIDE FOR MORE DETAILS.

| | | | | |
|---|--|-------------------------------------|--|--|
| <small>All Dimensions are in Millimeters</small> For Drawing Requirements, Refer to W1-08-03.01 Design Manual Fabrication: Structural Framework Designed I.A.W. EN 1991-1-4:2005+A1 Tolerances (U.O.S.): Linear ±2.0mm Angular ±1.0° Manufacturing: Material Lengths ±1.0mm Holes & Slots (Size and positioning) ±0.5mm Angular ±1.0° Design Code: EN 1990:2002+A1, EN 1991-1-4:2005+A1, Parts 1, 3 & 7 (Eurocodes) | | Debur and Break all Sharp Edges | ECR No. N/A Description of Change: First drawing, initial issue Date of Change: 27/08/2024 Drawn By: WHD Checked By: SYG | Title: 2 x 9 STA Modular Drawing Drawing No. Modular Layout Project No. M240263 Revision 1 Scale: 1 : 30 Sheet 1 of 1 |
| Material: AS PARTS Finish: AS PARTS Weight: N/A | Solarport Systems Ltd The Cove, Gore Cross Business Park Bridport Dorset DT6 3PH. T: +44 (0)1308 800 501 e: info@solarportsystems.com w: www.solarportsystems.com | | | A1 |