

NETATMO

BY
S+ARCK®

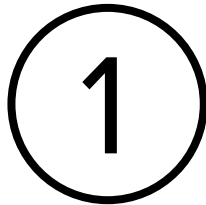

Replacing a wall-mounted thermostat



You can watch this installation at:
<http://netatmo.com/video1>

Warning!

- Read these instructions carefully before starting the installation.
- The Netatmo Thermostat must be installed according to applicable standards.
- Before any intervention, make sure power is turned off.
- The Netatmo Thermostat cannot control electric converters.

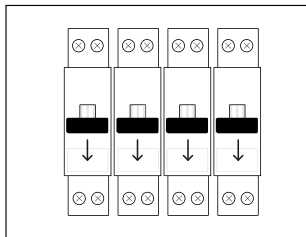
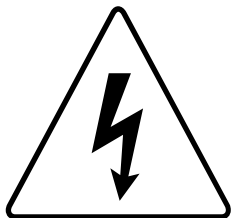

In the box

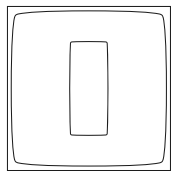

Thermostat

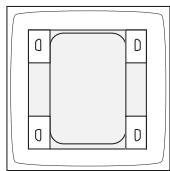

(Mobile stand)*

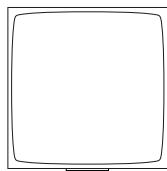

Relay

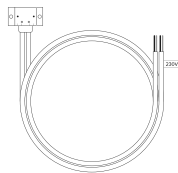

(Boiler adapter)*



Mounting Plate

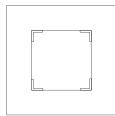

Trim plate

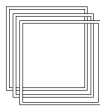

Color Adhesives



Power Plug



(Tape)*



3 AAA batteries



4 screws
4 screw anchors

** not used in this setup*

Relay

①

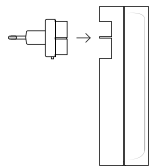

Plug the **Power Plug** into the **Relay**.

②

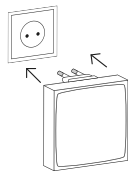

Plug the **Relay** into a wall socket in the same room as your existing thermostat.

③

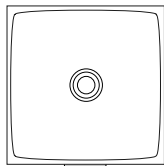

The **Relay** will blink white.

④

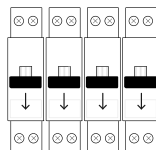

Switch off the power supply.

Identify

①

Remove the cover of your old thermostat.

Take a picture of the wiring.

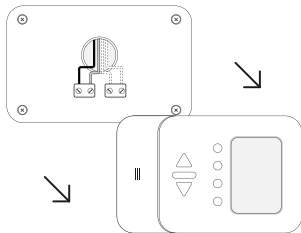

②

- If there are only two wires, they are the control wires and are useful in this setup.

- If there are more than two wires, identify

the two control wires. They are usually black or grey.

The wires can be identified as shown on the following diagram

Note: If there are more than two wires, the others are power supply wires and are useless here. They are usually brown, blue, green or yellow.

In doubt, please send a picture to photo@netatmo.com and our support team will help you identify the right wires

Control wires

Usually black
or grey wires

Power supply wires

Usually blue and
brown wires

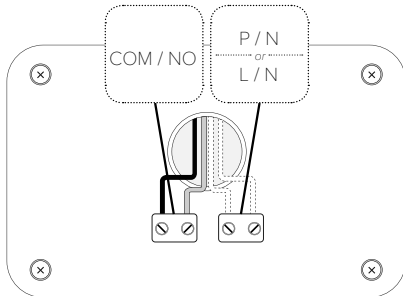

Replace

- ① Disconnect your old thermostat. Remove it from the wall.

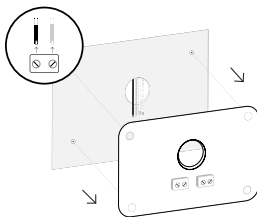

- ② Pass the wires through the Netatmo **mounting plate** and screw the latter to the wall. To hide potential scratches and holes left behind, use the **trim plate**.

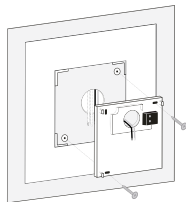

- ③ Screw the control wires previously identified into the electrical terminals and insulate the unused wires. Place and screw the **protection cover** onto the electrical terminals.

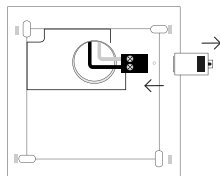

Customisation

①

You can choose to customize your **Thermostat** by using one of the **colour adhesives**.

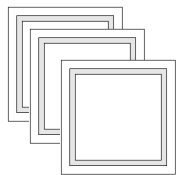

②

Take off the outer frame of the **adhesive**.

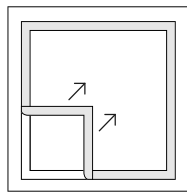

③

Stick it on the back of your **Thermostat**.

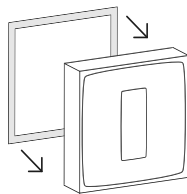

Thermostat

- ① Insert the batteries in the **Thermostat**.

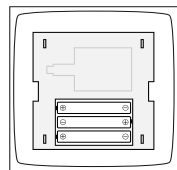

- ② Set the **Thermostat** on the mounting plate.

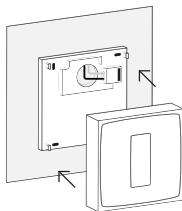

- ③ Switch the power supply back on.

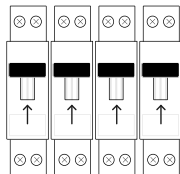

Thermostat

The **Thermostat** will display the start screen and search for the **Relay**.

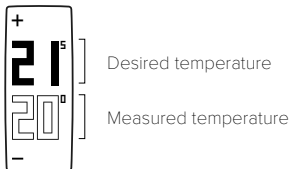
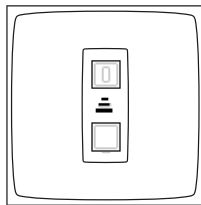

If the **Thermostat** has found the **Relay**, it displays the desired temperature and the room temperature.

.....
or
.....

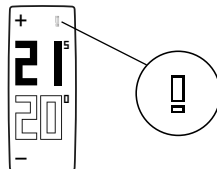

If the **Thermostat** hasn't found the **Relay**, it displays the «!» symbol. In this case, move the **relay** closer to the **Thermostat** and wait until the «!» symbol disappears.

Test

①

Push the top of the **Thermostat** until it displays « MAX ».

The **Thermostat** switches the boiler on.

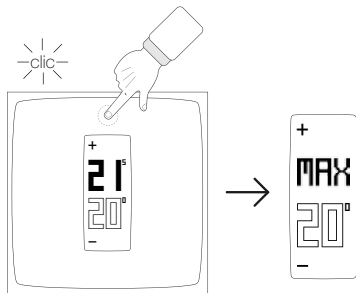

②

Push the bottom of the **Thermostat** until it displays « OFF ».

The **Thermostat** switches the boiler off.

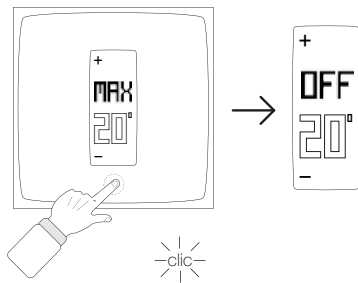

***Note:** If the Thermostat doesn't switch on and off the boiler, the control wires have been incorrectly wired. In this case, check your wiring using the picture of your old thermostat's wiring to identify the right control wires.*

If the boiler does the opposite of what is described (for example, it switches OFF when the Thermostat displays MAX), it means that you will have to change the polarity of the Thermostat. You can modify the polarity in the advanced settings of the app once you will have finished the setup.

App

To use your Thermostat from your smartphone or tablet, visit:

<http://therm.netatmo.com>

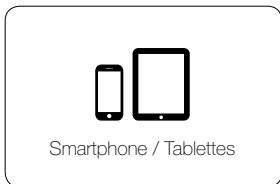

Specifications

SIZE

Thermostat: 83 x 83 x 22 mm

DESIGN

Designed by Starck.

Translucent minimalist plexiglass cube.
5 interchangeable colours in the box.

SENSORS AND MEASUREMENTS

Temperature (measurement):

Ranges from : 0°C à 50°C

Accuracy: +/- 0,1°C

Temperature (setpoint):

Ranges from: 5°C à 30°C

Increment: 0.5°C

Unit: °C

E-INK DISPLAY

Energy efficient, longer battery life and optimal readability.

FREE APP, LIFETIME SUPPORT

No subscription fee.

App available on the App Store,
Windows Phone Store and on
Google Play.

Free access to your online personal
dashboard.

Accessible from multiple devices.

WIRELESS SPECIFICATIONS

Wi-Fi 802.11 b/g/n compatible (2.4GHz).

Supported security: Open/WEP/WPA/
WPA2-personal (TKIP and AES).

Wireless connection between thermostat and
relay:
radio long range 100 m.

POWER AND BATTERIES

3 AAA batteries.

2 years battery life.

SETUP AND COMPATIBILITY

Compatible with gas, fuel, wood boilers
and heat pumps.

Switching current: max 4 A

Switching voltage: max 250 VAC

Switching power: max 120 W

HOMEKIT

Controlling HomeKit-enabled accessories away
from home requires an Apple TV (3rd generation
or later) with Apple TV software 7.0 or later and an
iPhone, iPad, or iPod touch with iOS 8.1 or later.

EU Declaration of Conformity

We, Netatmo, declare that this device is in compliance with the essential requirements and other relevant provisions of Directive 1999/5/EC.

Safety warnings

This device must be installed according to the applicable norms. Use only with supplied power plug adaptor and boiler adaptor. This device is for indoor use only.

Before inserting the batteries, check that the contacts in the device and on the batteries are clean, is necessary clean them. Note the polarity (+/-) when inserting the batteries. Do not throw the batteries into a fire, short-circuit them or dismantle them. Keep children away from batteries. Seek medical attention immediately if a battery is swallowed. Do not attempt to repair the device yourself; customer service is available. Any changes or modifications to this unit not expressly approved by the party responsible for compliance could void the user's authority to operate the equipment. Thermostat and

relay insulation: class II devices. This device is not intended for use by persons (including children) with reduced physical, sensory or mental capabilities, or lack of experience and knowledge, unless they have been given supervision or instruction concerning use of the appliance by a person responsible for their safety. Children should be supervised to ensure that they do not play with the appliance.

Legal notice

Use of the HomeKit logo means that an electronic accessory has been designed to connect specifically to iPod, iPhone, or iPad, respectively, and has been certified by the developer to meet Apple performance standards. Apple is not responsible for the operation of this device or its compliance with safety and regulatory standards.

Please note that the use of this accessory with iPod, iPhone, or iPad may affect wireless performance.



<http://support.netatmo.com>

