

# GSE **IN-ROOF SYSTEM**™

## PORTRAIT & PORTRAIT EVOLUTION Installation manual - 50mm battens

V 1.1



## Contents

<b>1. Kit presentation</b>	<b>4</b>
1.1 Presentation of the GSE IN-ROOF SYSTEM™	4
1.2 Kit components	5
1.3 Tools required for installation	6
1.4 GSE PORTRAIT Evolution (Half-frame)	7
1.5 GSE PORTRAIT (Full frame)	8
1.6 GSE clamps	9
<b>2. Site preparation</b>	<b>10</b>
2.1 Climatic Conditions	10
2.2 Position of the PV array on the roof	10
2.3 Defining wind pressure of the project & number of clamps per module	11
2.4 Calculating the size of the PV array	12
<b>3. Installation steps</b>	<b>13</b>
3.1 Overall presentation of the GSE IN-ROOF SYSTEM PORTRAIT	13
3.2 Layout of support battens	14
3.3 Installation of the bottom PV field connection	20
<b>3.3.1 In the middle of the roof</b>	<b>20</b>
3.3.1.1) Laying of the inclined batten	20
3.3.1.2) OPTION 1 - Installation of the bottom waterproofing strip <i>For all types of tile</i>	21
3.3.1.3) OPTION 2 - Installation of the bottom semi-rigid flashing <i>For all types of tile except deep-curve tiles</i>	22
<b>3.3.2 Connection to the gutter</b>	<b>23</b>

# Contents

3.4 GSE IN-ROOF SYSTEM frames installation	25
3.5 <i>OPTIONAL STEP – Installation of the microinverters and their cabling</i>	29
3.6 Lateral flashings installation	30
3.7 <i>OPTIONAL STEP – Intermodule flashings installation</i>	32
3.8 PV modules installation	33
3.9 Installation of the top PV field connection	36
3.9.1) OPTION 1 - Top flashings installation	36
3.9.2) OPTION 2 - Top waterproofing strip & tile support installation	39
3.10 Connection to the roof covering	40
3.11 Specific case: PV array with inner/outer angles	40
<b>4. Maintenance and servicing</b>	<b>42</b>
4.1 Verification	42
4.2 Module replacement	42
<b>5. Support and Contact</b>	<b>43</b>
5.1 Training sessions	43
5.2 Technical assistance	43
<b>6. Certifications and guarantees</b>	<b>43</b>
6.1 Technical assessments	43
6.2 Fire tests	43
6.3 Guarantees	43

# 1. Kit presentation

## 1.1 Presentation of the GSE IN-ROOF SYSTEM™

**GSE IN-ROOF SYSTEM PORTRAIT** allows modules to be installed **on all types of roofing (slates, flat interlocking tiles, slight-curve tiles, deep-curve tiles)** on new buildings or renovations.

It can be installed in **portrait format** on both small installations (less than 3 kWp) and large roofs.

**GSE IN-ROOF SYSTEM PORTRAIT** must be installed on the wooden or metallic substructure of the buildings and mounted on specific battens, adapted to climatic conditions. It can be mounted on slopes between **12° and 50°**.

Before installing the **GSE IN-ROOF SYSTEM PORTRAIT**, we strongly recommend that you join us on our **CONNECTOR** platform, created to help installers make their project a success.

- Watch our training videos.
- Use our configurator for your project to obtain the PV field dimensions and full material list



TRAINING



TOOLS AND CALCULATION



HELP CENTER



DOCUMENTATIONS

1.2 Kit components

MOUNTING FRAMES



Half frames



Frames

MOUNTING CLAMPS



Self-drilling  
wood screws  
6.5 x 60  
or 6.5 x 45\*



End clamp +  
EPDM foam



Middle clamp  
+ EPDM foam



Edge wedges  
(L/R)

TOP & LATERAL CONNECTIONS



Flashing  
Hook\*\*



Lateral  
Flashing



Pre-compressed  
foam



Top Flashing



Attach angle



Aluminium  
Pop Rivet



Top Flashing  
Junction

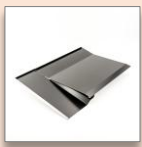

Corner  
Flashing



Flexalu  
330MM™  
or eq.

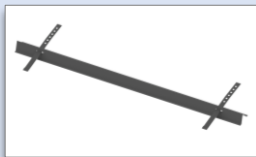

Tile Support & Long  
Hooks

(except for slates and  
flat tiles)

OPTION 1

OPTION 2

BOTTOM CONNECTION



Waterproofing  
strip certified



Bottom Semi-  
rigid flashing

OPTION 1

OPTION 2

\* A 60 mm length screw is adapted to an installation with vertical counter battens and horizontal support battens. In case of a different installation principle, it is the responsibility of the installer to use a screw with adapted length.

\*\* Nails / screws for fixing the flashing hook not sourced by GSE Integration

### 1.3 Tools required for installation

SCREWDRIVER



DRILL BITS WOOD AND METAL OF 10MM



HEX BIT 8MM



*Adjustable tightening torque mandatory*

AVIATION SNIP



RIVET GUN



HAMMER



MEASURING TAPE



CHALK LINE

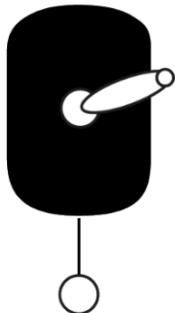

MARKING ACCESSORIES

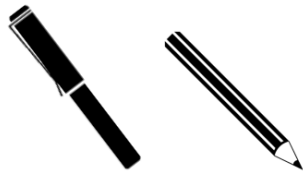

*White marker, pencil, etc.*



1.4 GSE PORTRAIT Evolution (Half-frame)

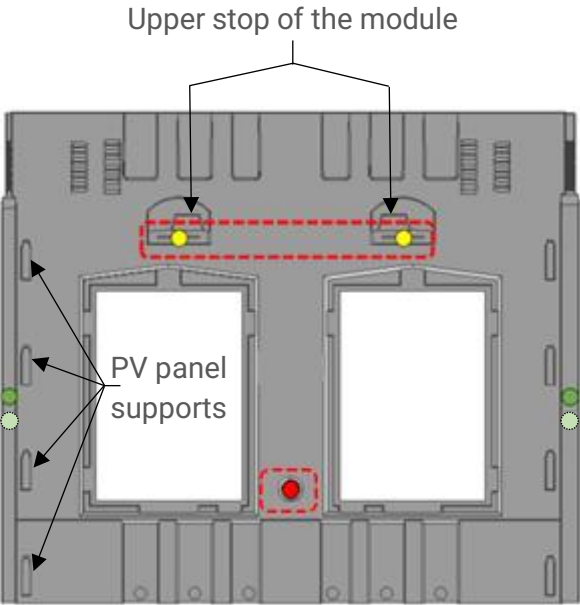

- Frame fixing point  
(**already placed, without pre-drilling**)
- Frame fixing point  
(**already pre-drilled at 10mm**)
- Clamp fixing point (4 & 8 clamps) (**lateral interlocking needing a 10mm pre-drilling**)

HALF-PORTRAIT FRAME REFERENCES – MODULES SIZES

Overlapping area graduation

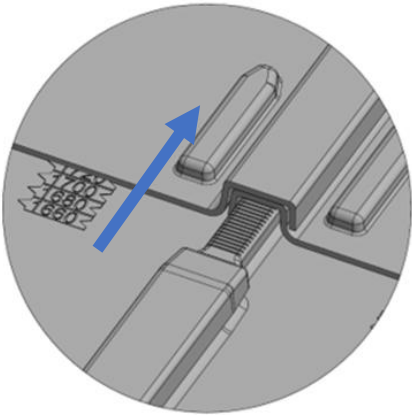

		PV module dimensions				
		Height			Width	
	Réf.	Min. tolerated	Min. suggested	Max.	Min. suggested	Max.
PORTRAIT Version 2022	DPo_1650_995	1570	1610	1800	991	995
	DPo_1650_1070	1570	1610	1800	1066	1070
	DPo_1650_1100	1570	1610	1800	1096	1100
	DPo_1650_1135	1570	1610	1800	1131	1135
	DPo_1650_1140	1570	1610	1800	1136	1140
	DPo_1650_1145	1570	1610	1800	1141	1145
	DPo_1650_1160	1570	1610	1800	1156	1160
	DPo_1840_995	1760	1800	1990	991	995
	DPo_1840_1020	1760	1800	1990	1016	1020
	DPo_1840_1030	1760	1800	1990	1026	1030
	DPo_1840_1040	1760	1800	1990	1036	1040
	DPo_1840_1045	1760	1800	1990	1041	1045
	DPo_1840_1050	1760	1800	1990	1046	1050
	DPo_1840_1070	1760	1800	1990	1066	1070
	DPo_1840_1090	1760	1800	1990	1086	1090
	DPo_1840_1100	1760	1800	1990	1096	1100
	DPo_1840_1135	1760	1800	1990	1131	1135
	DPo_2030_995	1950	1990	2180	991	995
	DPo_2030_1040	1950	1990	2180	1036	1040
	DPo_2030_1050	1950	1990	2180	1046	1050
	DPo_2030_1055	1950	1990	2180	1051	1055
	DPo_2030_1135	1950	1990	2180	1131	1135
	DPo_2030_1305	1950	1990	2180	1301	1305

1.5 GSE PORTRAIT (Full frame)

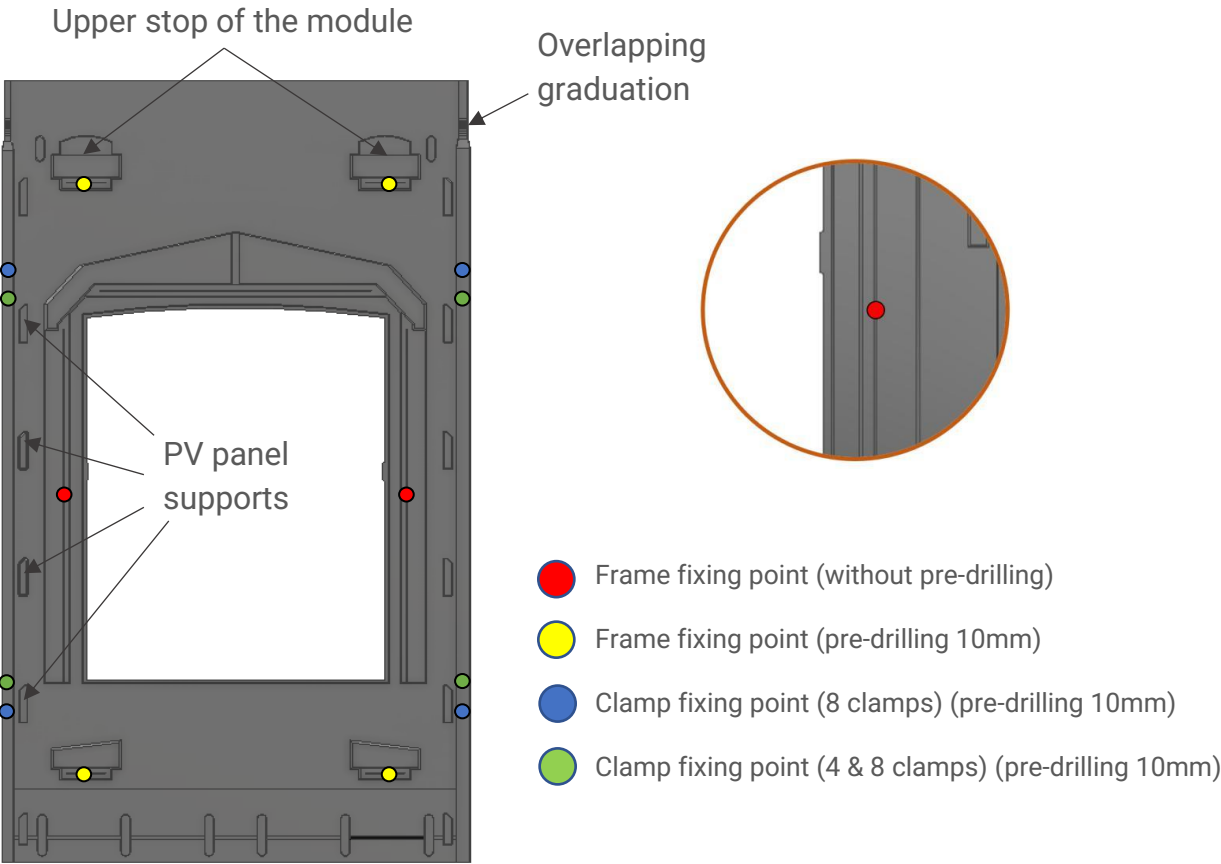

PORTRAIT FRAME REFERENCES – MODULES SIZES

Overlapping area graduation

Height Tolerance

Width Tolerance

		PV module dimensions					
		Height			Width		
		Min. tolerated	Min. suggested	Max.	Min. suggested	Max.	
PORTRAIT	Version 2020	1710_995	1630	1670	1780	991	995
		1710_1000	1630	1670	1780	996	1000
		1710_1005	1630	1670	1780	1001	1005
		1710_1010	1630	1670	1780	1006	1010
		1710_1020	1630	1670	1780	1016	1020
		1710_1025	1630	1670	1780	1021	1025
		1710_1030	1630	1670	1780	1026	1030
		1710_1040	1630	1670	1780	1036	1040
		1710_1045	1630	1670	1780	1041	1045
		1710_1050	1630	1670	1780	1046	1050
		1710_1055	1630	1670	1780	1051	1055
		1710_1060	1630	1670	1780	1056	1060



# 1.6 GSE Clamps

## END CLAMPS

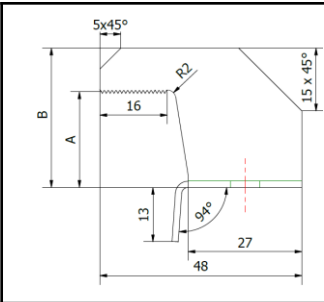

Description	A (mm)	B (mm)
End Clamp H16	17,8	27,8
End Clamp H19	20,8	30,8
End Clamp H21	22,8	32,8
End Clamp H23	24,8	34,8

## MIDDLE CLAMPS

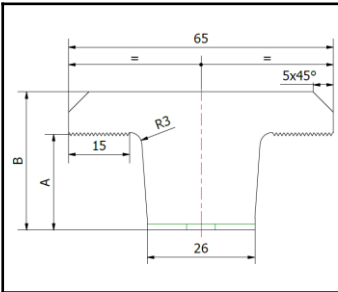

Description	A (mm)	B (mm)
Middle Clamp H16	18,6	28,6
Middle Clamp H19	21,6	31,6
Middle Clamp H21	23,6	33,6
Middle Clamp H23	25,6	35,6

## CORRELATION CLAMPS / MODULES THICKNESS

### Full Frames (2020)

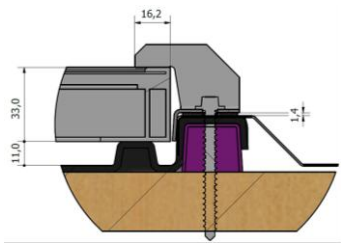

### Half Frames

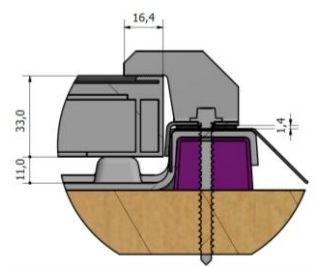

Clamps size	Module thickness (mm)		
	GSE In-Roof V2012	GSE In-Roof V2012 - P33	GSE In-Roof V2020 & V2022
H16	35-37 mm	32-34 mm	30-32 mm
H19	38-39 mm	35-36 mm	33-34 mm
H21	40-41 mm	37-38 mm	35-36 mm
H23	42-44 mm	39-41 mm	37-39 mm

**INFO:** You can find the full correlation table on our **CONNECTOR** tool in the documentation tab.

To access it, log on to <https://connector-gseintegration.com/auth/login/>

## 2. Site preparation

The installer must proceed to a measurement work beforehand, in order to guarantee the durability and performance of the PV array installed. Climatic conditions of the project (ie. wind and snow<sup>1</sup>) and PV array layout should be considered according to current regulations (Eurocodes and BS 5534).

This data will help to **check if the system is suitable for the project conditions**. The thickness of the support battens must be adapted to the roof battens to ensure the junction with the roof covering is watertight.

### 2.1 Climatic Conditions

Climatic load according to Eurocode 1 and BS 5534 :



Geographical wind zone	Wind speed (m/s)	Design Wind Pressure (kN/m²)
1	22	0,820
2	24	0,975
3	26	1,150
4	28	1,330
5	30	1,600

Maximum design wind uplift resistance : **3,44 kN/m²**  
(According to MCS 012 KIWA00041 certificate)

### 2.2 Position of the PV array on the roof

The location of the PV array has an influence on the wind load value whether it is in the centre, on the edge or in the corner of the roof. The worst case should be taken into account.

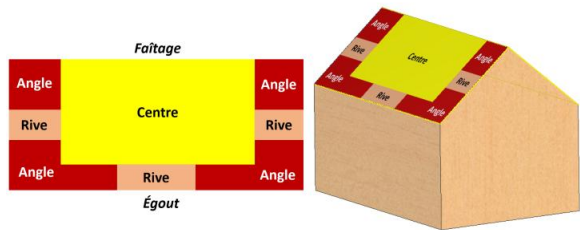

TWO-SLOPED ROOF

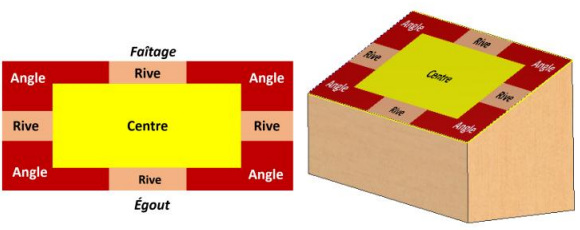

ONE-SLOPED ROOF

<sup>1</sup>The seismic resistance of the GSE In-Roof System is validated on the whole European territory. This criterion is not to be taken into account.

## 2.3 Defining wind pressure of the project & number of clamps per module

To calculate the wind load on the PV array, you need to priorly know the following parameters:

- Location of the project
  - Altitude
  - Type of terrain
  - Distance from the shoreline
- Ridge height
  - Roof pitch
  - Roof zone (Centre, Edge, Corner)

Ideally, climatic load (and especially wind load) should be calculated for each project, but you can refer to the tables below, if all conditions matches with those of the project.

**Fixed Conditions:**

- Terrain category: **Country terrain** (including Town Terrain)
- Distance from the shoreline: **10 km**
- Battens dimension: **25 x 50mm**

**GSE IN-ROOF SYSTEM PORTRAIT**  
**Wind Uplift Resistance (MCS012 Testing):**

- **4 Clamps: 2,07 kN/m²**
- **8 Clamps: 3,44 kN/m²**

**1<sup>st</sup> case: Roof pitch ≥ 25°**

Ridge Height	Location on the Roof	Zone 1 (Alt ≤ 250m)	Zone 2 (Alt ≤ 200m)	Zone 3 (Alt ≤ 130m)	Zone 4 (Alt ≤ 100m)	Zone 5 (Alt ≤ 50m)
6 m	Center	1,26 kN	1,38 kN	1,44 kN	1,58 kN	1,65 kN
	Edges	1,46 kN	1,60 kN	1,67 kN	1,83 kN	1,92 kN
	Corners	1,56 kN	1,72 kN	1,78 kN	1,96 kN	2,05 kN
8 m	Center	1,37 kN	1,51 kN	1,57 kN	1,72 kN	1,80 kN
	Edges	1,59 kN	1,75 kN	1,82 kN	2,00 kN	2,09 kN
	Corners	1,71 kN	1,87 kN	1,95 kN	2,14 kN	2,24 kN
10 m	Center	1,43 kN	1,57 kN	1,63 kN	1,79 kN	1,88 kN
	Edges	1,66 kN	1,82 kN	1,90 kN	2,08 kN	2,18 kN
	Corners	1,78 kN	1,95 kN	2,03 kN	2,23 kN	2,33 kN

**2<sup>nd</sup> case: Roof pitch ≥ 35°**

Ridge Height	Location on the Roof	Zone 1 (Alt ≤ 250m)	Zone 2 (Alt ≤ 200m)	Zone 3 (Alt ≤ 150m)	Zone 4 (Alt ≤ 100m)	Zone 5 (Alt ≤ 50m)
6 m	Center	1,09 kN	1,19 kN	1,29 kN	1,36 kN	1,43 kN
	Edges	1,36 kN	1,49 kN	1,61 kN	1,71 kN	1,78 kN
	Corners	1,43 kN	1,57 kN	1,69 kN	1,79 kN	1,87 kN
8 m	Center	1,19 kN	1,30 kN	1,40 kN	1,49 kN	1,56 kN
	Edges	1,48 kN	1,63 kN	1,75 kN	1,86 kN	1,95 kN
	Corners	1,56 kN	1,71 kN	1,84 kN	1,95 kN	2,04 kN
10 m	Center	1,24 kN	1,36 kN	1,46 kN	1,55 kN	1,62 kN
	Edges	1,55 kN	1,69 kN	1,83 kN	1,94 kN	2,03 kN
	Corners	1,62 kN	1,78 kN	1,92 kN	2,04 kN	2,13 kN

2.4 Calculating the size of the PV array

INFO: Use our CONNECTOR tool available on our web site at <https://connector-gseintegration.com/auth/login/> to determine the dimensions of your PV field.

2.4.1 PV Array Size Calculation Portrait Evolution - Half-Frames

The field size is calculated from the GSE plate reference used (refer to sections 1.4, 1.5 and 1.6 to determine the GSE plate compatible with the module):

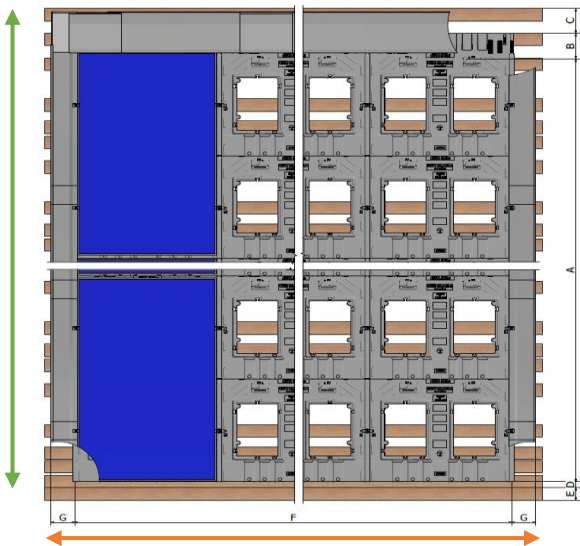

**Field height (mm) = (mm)**  
((Ref. Height + Graduation + 10) x Nb. Lines) +  
160 + 150 + 50 + 100² (Ref. Height + Graduation)

**A + B + C + D + E**

**Field width (mm) = (mm)**

((Ref. width + 40)  
x Nb. Columns) + (2 x 170)

**F + 2 x G**

²If installed in the middle of the roof, add a board to equalise with curve height (see 3.4).

Demi-Plaques GSE In-Roof v.2022 - PORTRAIT																				
Hauteur Réf	1650	1650	1650	1650	1650	1650	1650	1840	1840	1840	1840	1840	1840	1840	1840	1840	1840	2030	2030	2030
Largeur Réf	995	1070	1100	1135	1140	1145	1160	995	1020	1030	1040	1045	1050	1070	1090	1100	1135	995	1050	1055

2.4.2 PV Array Size Calculation Portrait – Full Frames

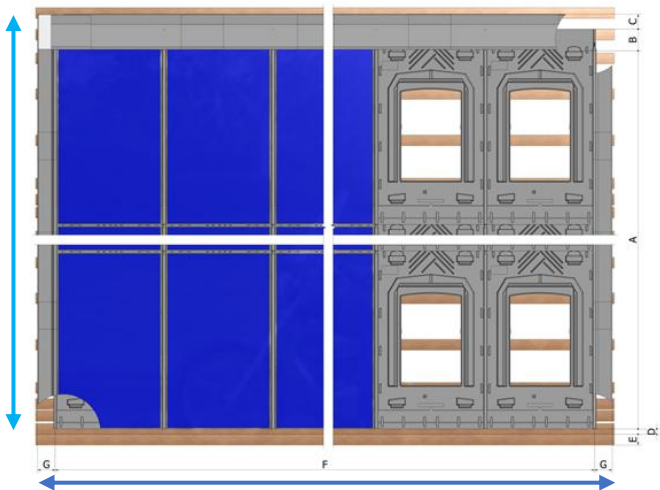

**Field height (mm) = (mm)**  
((Ref. Height + Graduation + 10) x Nb. Lines)  
+ 160 + 150 + 50 + 100².

**A + B + C + D + E**

**Field width (mm) = (mm)**  
((Width Ref. + 36.5) x Nb. Columns) + (2 x 170)

**F + 2 x G**

²If installed in the middle of the roof, add a plank to compensate for the curvature of the tile (see 3.3).

Plaques GSE - PORTRAIT																
Hauteur Réf	1580	1575	1575	1575	1640	1640	1686	1710	1710	1710	1710	1710	1710	1710	1710	1710
Largeur Réf	808	1046	1053	1082	992	1001	1016	995	1000	1005	1010	1020	1025	1030	1040	1055

### 3. Installation steps

#### 3.1 Overall presentation of the GSE IN-ROOF SYSTEM PORTRAIT

OVERALL PRESENTATION OF THE INSTALLATION STEPS OF THE KIT :

- 1/ Positioning of the support battens

2/ Frames installation

3/ Flashings installation
- 4/ PV modules installation

5/ Connection of the roof covering on top bottom and lateral PV field

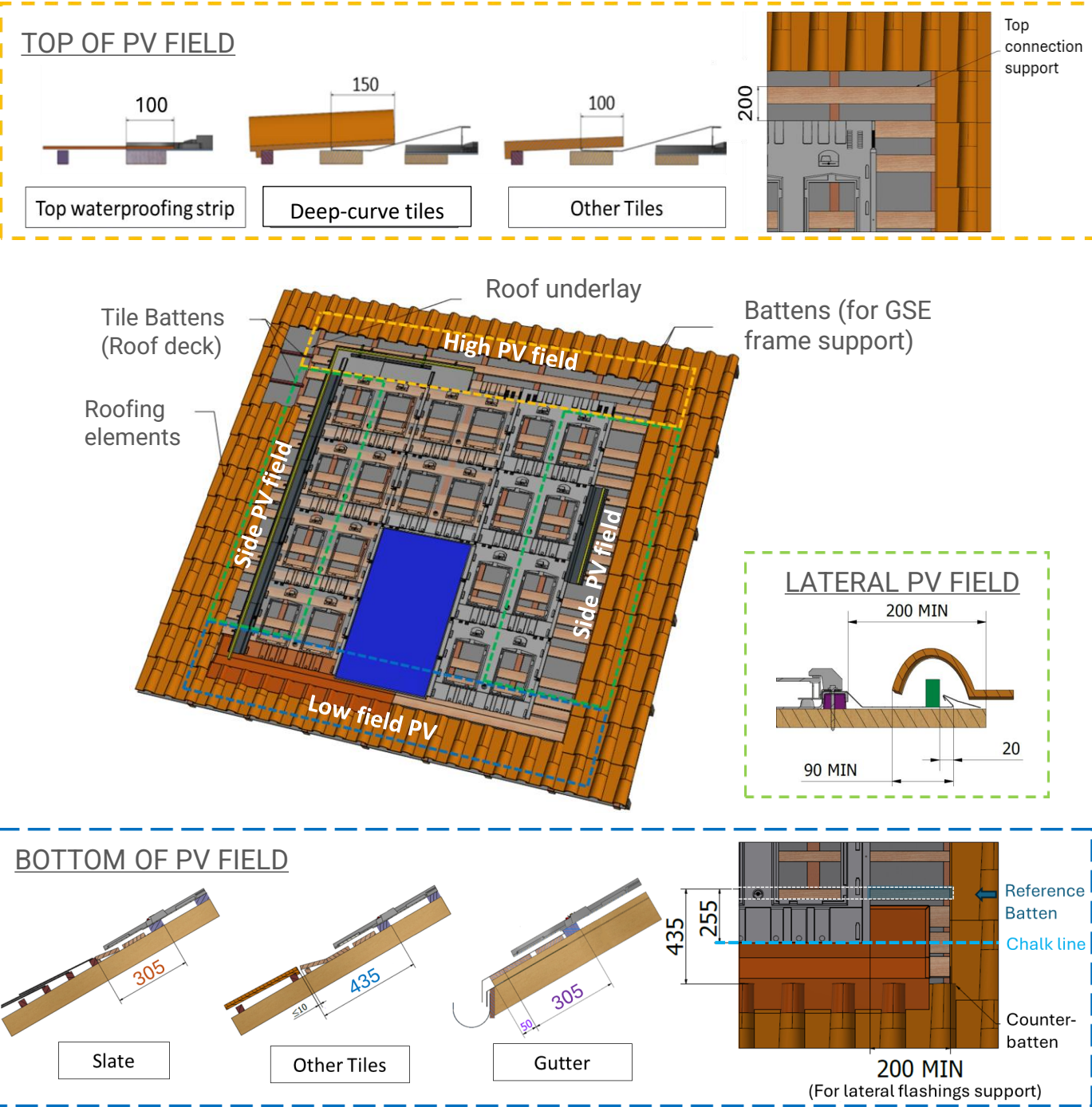



### 3.2 Layout of support battens

If the roof is covered, uncover the roof to the dimensions of the field calculated above, removing 1 or even 2 extra rows (for slate or flat tile roofing) from the sides and top:

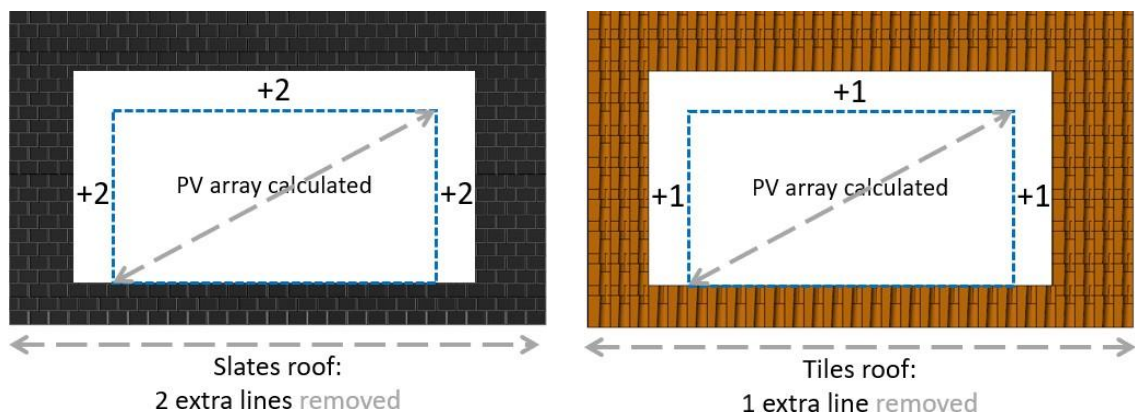

**WARNING:** PRIOR TO STARTING ANY WORK, THE INSTALLER MUST ENSURE THAT THE FRAMEWORK IS FLAT AND THERE MUST BE A ROOF UNDERLAY ACCORDING TO THE BUILDING STANDARD BS 5534.

If not, check that the field dimensions calculated previously are compatible with the dimensions of the roof. Use the dimensions of the PV array to center it horizontally and vertically on the roof, especially if it is installed in the middle of the roof.

- 1 Beforehand, determine the number of clamps (see section 2).
- 2 For **mid-roof installation**, position the **reference batten** (in blue below) of the 1<sup>st</sup> half-frame line in relation to the lower line of tiles/slates as shown in the diagrams below:

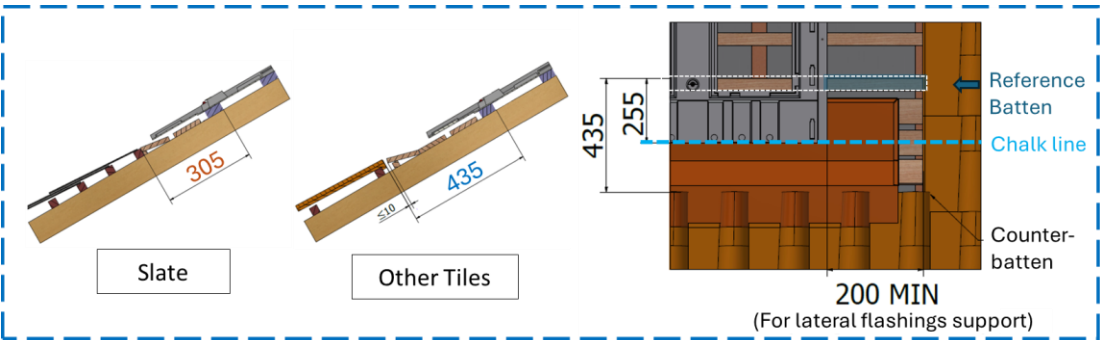

**Batten fastening :**  
We recommend using 5x80 mm self-drilling wood screws.

For **gutter installation**, position the reference batten (in blue on the diagram) of the 1<sup>st</sup> half-plate line in relation to the gutter as shown in the adjacent diagram:

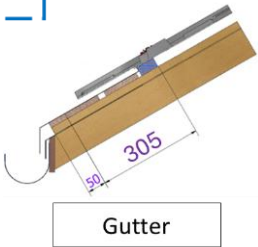

3 Position the other battens supporting the Portrait frames and half-frames in relation to the first reference batten:

- 1/ Battens for fixing clamps
- 2/ Battens for the frames' fixing points
- 3/ Battens for the frames' support & overlaps <sup>1</sup>
- 4/ Battens to offer a flat support of **18 mm thick** for the waterproofing strip.<sup>2</sup>
- 5/ Battens to support the top flashings or the top waterproofing strip

**By following the lathing plans shown on the following pages.**

1 - As these elements have no role to play in the mechanical strength of the system, the width of the timbers may be different from the one needed for the clamps (of minimum 50mm). **Only the thickness must be the same.**

2 - The thickness of the battens supporting the bottom waterproofing strip must be max 18mm to avoid creating any extra thickness (via the waterproofing strip) below the first row of frame.

**INFO: All our PORTRAIT and HALF-PORTRAIT battening plans are available on our CONNECTOR tool in the documentation tab.**

**To access it, log on to <https://connector-gseintegration.com/auth/login/>**



Overlapping

Overlapping

Clamp fixation

Frame fixation

Overlapping

Overlapping

Clamp fixation

Frame fixation

Support for Waterproofing strip

Sloping batten to connect curved tiles

Reference Batten

4 clamps

95-170

735

510

180

255 Frame

150

230 Slab

150 Tile

100

205

510

735

180

100

Fourth line Half-Frame

Third line Half-Frame

Second line Half-Frame

First line Half-Frame

PV module next line

PV module first line

Please refer to the adjacent table:

Panel length	First line	Additional line	Adjustment
≤1650	450 (ou 330) + 735	95 + 735	0
1660	450 (ou 330) + 735	100 + 735	5
1670	450 (ou 330) + 735	105 + 735	10
1680	450 (ou 330) + 735	110 + 735	15
1690	450 (ou 330) + 735	115 + 735	20
1700	450 (ou 330) + 735	120 + 735	25
1710	450 (ou 330) + 735	125 + 735	30
1720	450 (ou 330) + 735	130 + 735	35
1730	450 (ou 330) + 735	135 + 735	40
1740	450 (ou 330) + 735	140 + 735	45
1750	450 (ou 330) + 735	145 + 735	50
1760	450 (ou 330) + 735	150 + 735	55
1770	450 (ou 330) + 735	155 + 735	60
1780	450 (ou 330) + 735	160 + 735	65
1790	450 (ou 330) + 735	165 + 735	70
1800	450 (ou 330) + 735	170 + 735	75

BATTENING PLAN FOR PORTRAIT EVOLUTION HALF-FRAMES OF  
REFERENCE HEIGHT 1840 MM WITH 4 CLAMPS

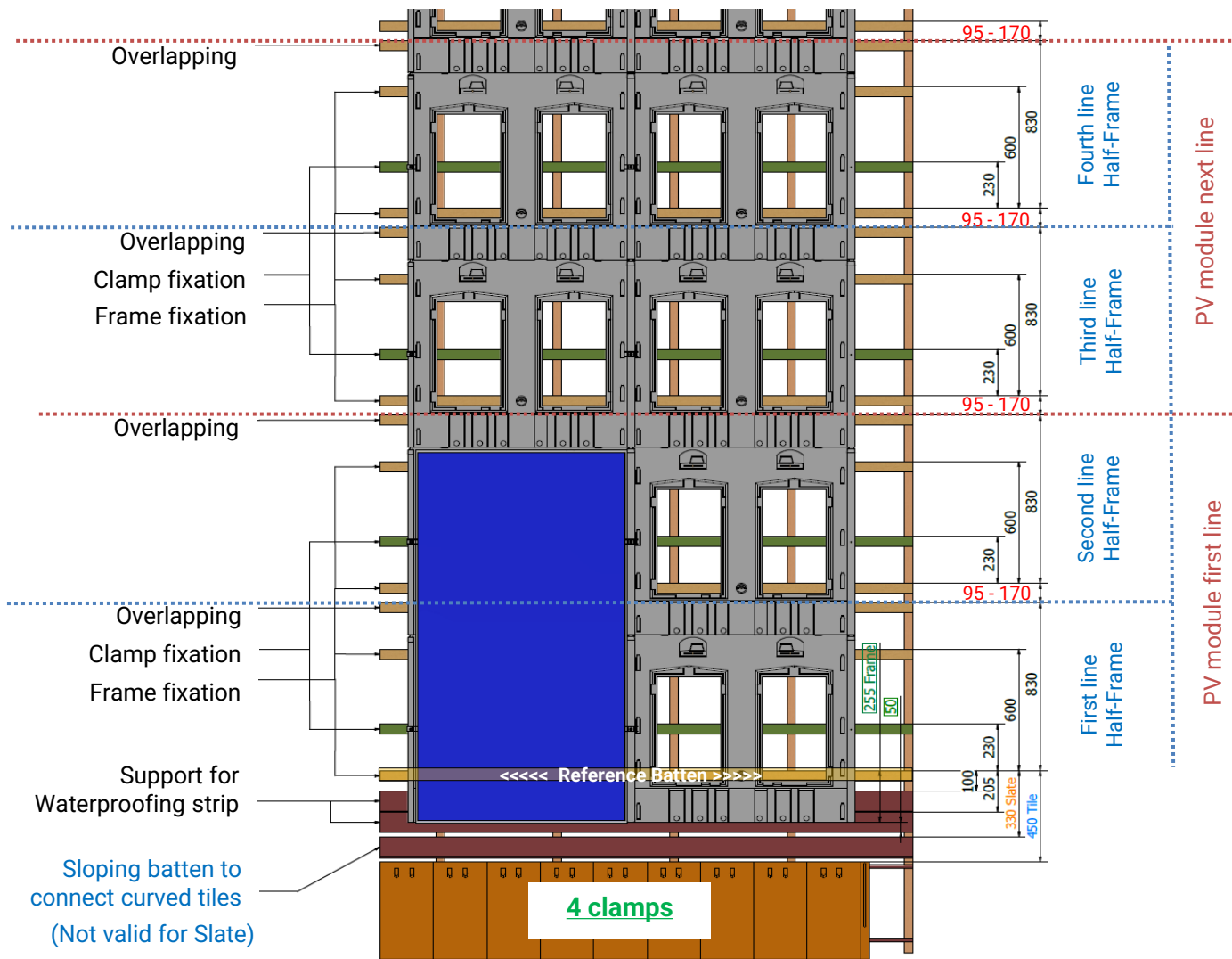

Define the **line spacing annotated in red** in the plan above (**between 95 and 170mm**) in relation to the length of PV module to be installed (and therefore the adjustment required between the half-frames).  
Please refer to the adjacent table:

Panel length	First line	Additional line	Adjustment
≤1840	450 (ou 330) + 830	95 + 830	0
1850	450 (ou 330) + 830	100 + 830	5
1860	450 (ou 330) + 830	105 + 830	10
1870	450 (ou 330) + 830	110 + 830	15
1880	450 (ou 330) + 830	115 + 830	20
1890	450 (ou 330) + 830	120 + 830	25
1900	450 (ou 330) + 830	125 + 830	30
1910	450 (ou 330) + 830	130 + 830	35
1920	450 (ou 330) + 830	135 + 830	40
1930	450 (ou 330) + 830	140 + 830	45
1940	450 (ou 330) + 830	145 + 830	50
1950	450 (ou 330) + 830	150 + 830	55
1960	450 (ou 330) + 830	155 + 830	60
1970	450 (ou 330) + 830	160 + 830	65
1980	450 (ou 330) + 830	165 + 830	70
1990	450 (ou 330) + 830	170 + 830	75

Overlapping

Added batten for clamp fixation

Overlapping

Clamp fixation

Frame fixation

Added batten for clamp fixation

Overlapping

Added batten for clamp fixation

Overlapping

Clamp fixation

Frame fixation

Added batten for clamp fixation

Support for Waterproofing stip

Sloping batten to connect curved tiles  
(Not valid for Slate)

85-160

930

700

275

85-160

930

700

275

85-160

930

700

275

85-160

930

700

275

100

205

330 Slate

450 Tile

280 Frame

50

Reference Batten

First line Half-Frame

Second line Half-Frame

Third line Half-Frame

Fourth line Half-Frame

PV module next line

PV module first line

8 clamps

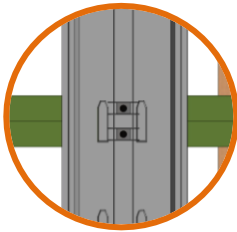

Please refer to the adjacent table:

Panel length	First line	Additional line	Adjustment
≤2030	450 (ou 330) + 930	85 + 930	0
2040	450 (ou 330) + 930	90 + 930	5
2050	450 (ou 330) + 930	95 + 930	10
2060	450 (ou 330) + 930	100 + 930	15
2070	450 (ou 330) + 930	105 + 930	20
2080	450 (ou 330) + 930	110 + 930	25
2090	450 (ou 330) + 930	115 + 930	30
2100	450 (ou 330) + 930	120 + 930	35
2110	450 (ou 330) + 930	125 + 930	40
2120	450 (ou 330) + 930	130 + 930	45
2130	450 (ou 330) + 930	135 + 930	50
2140	450 (ou 330) + 930	140 + 930	55
2150	450 (ou 330) + 930	145 + 930	60
2160	450 (ou 330) + 930	150 + 930	65
2170	450 (ou 330) + 930	155 + 930	70
2180	450 (ou 330) + 930	160 + 930	75

BATTENING PLAN FOR PORTRAIT FULL FRAMES OF REFERENCE  
HEIGHT 1710MM WITH 4 CLAMPS

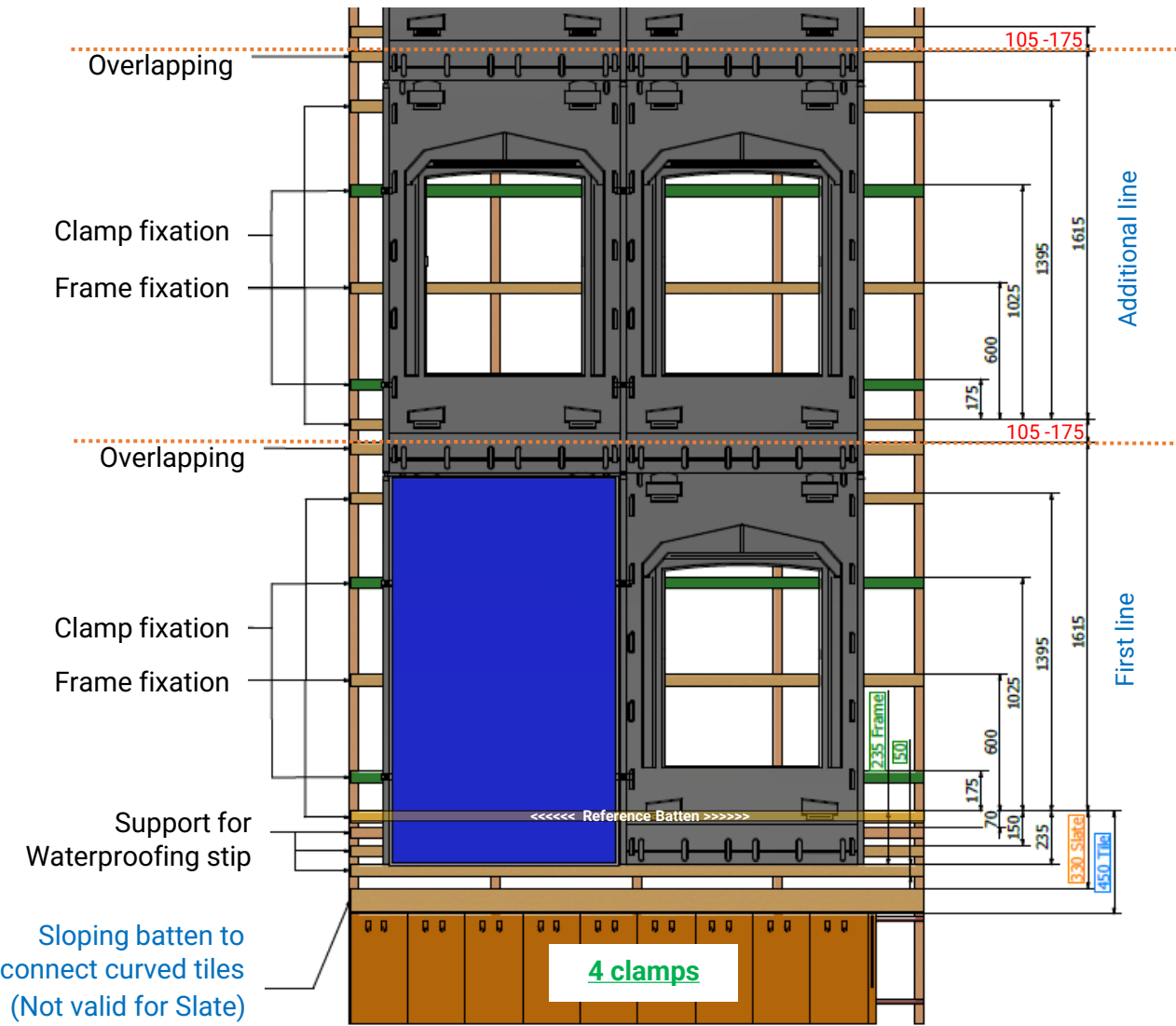

Define the **line spacing annotated in red** in the plan above (**between 150 and 220mm**) in relation to the length of PV module to be installed (and therefore the adjustment required between the half-plates).

Please refer to the adjacent table:

Panel length	First line	Additional line	Adjustment
≤1710	450 (or 330) + 1615	105 + 1615	0
1720	450 (or 330) + 1615	115 + 1615	10
1730	450 (or 330) + 1615	125 + 1615	20
1740	450 (or 330) + 1615	135 + 1615	30
1750	450 (or 330) + 1615	145 + 1615	40
1760	450 (or 330) + 1615	155 + 1615	50
1770	450 (or 330) + 1615	165 + 1615	60
1780	450 (or 330) + 1615	175 + 1615	70

### 3.3 Installation of the bottom PV field connection

#### 3.3.1 In the middle of the roof

##### 3.3.1.1) Laying of the inclined batten (except on slate roofs)

The waterproofing strip is laid to connect the bottom of the PV field to the roofing elements. For roofs with mechanical tiles, flat tiles or steeply curved tiles, a "chanlatte" type batten is laid to take up the curvature of the tile and provide a flat support for the waterproofing strip.

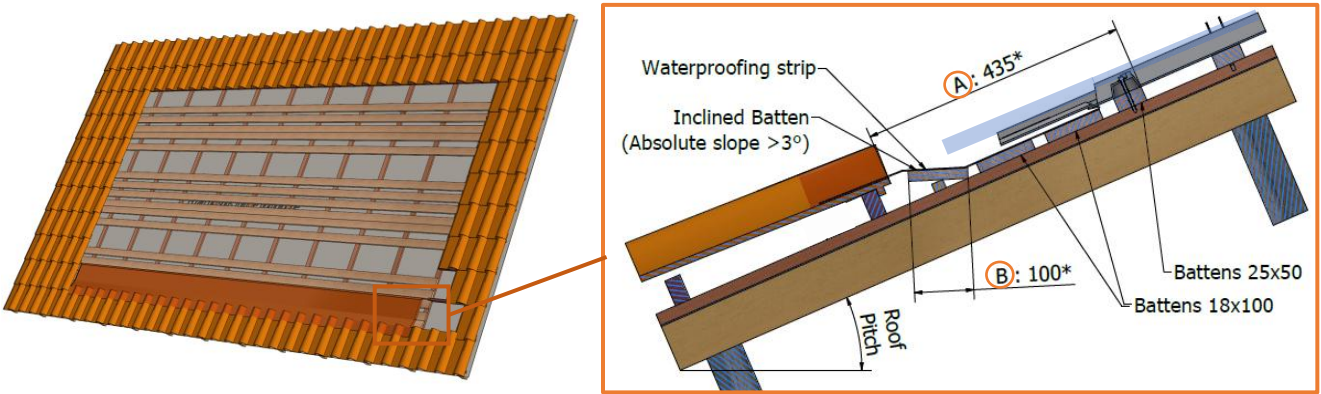

The width of the inclined batten is determined by the slope of the roof (as it must not create a counter-slope) and by definition determines the necessary distance between the reference batten and the row of tiles at the bottom of the PV field. **It should be no more than 18mm thick.**

Roof pitch		MIN width of inclined batten	MIN distance Reference batten / Tiles	Sealing strip width MIN
(°)	(%)	DIMENSION B (mm)	DIMENSION A (mm)	(mm)
12 à 19	21 à 35	200	515	560
20 à 23	36 à 43	130	435	500
24 à 50	44 à 50	100	435	500

If the tiles are laid with strong curves, the inclined batten is laid flush with the currents. In the case of very steeply curved tiles, it may be advisable to chamfer the top of the tile curve.

There is no need of a sloping batten for slate or gutter installations.

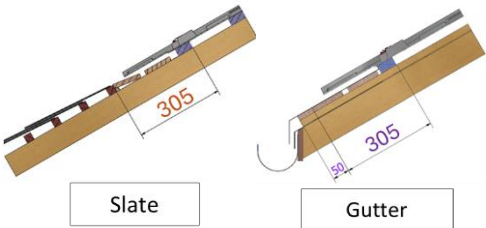



For all bottom PV field connections in the middle of the roof:

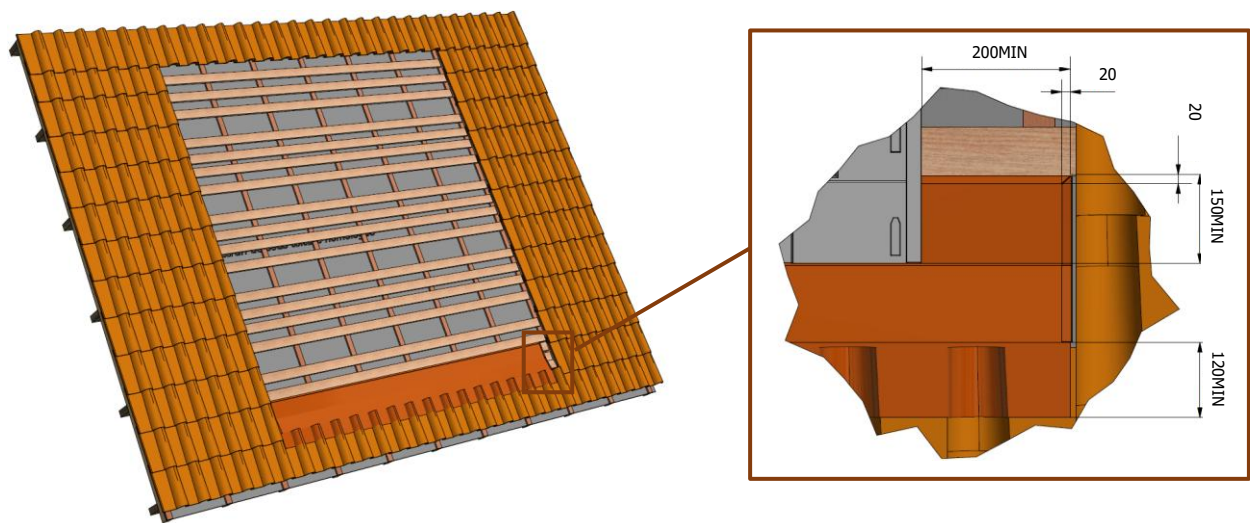

3.3.1.2) OPTION 1 – Installation of the bottom waterproofing strip  
*Installation possible on any roofing elements*

**PLEASE NOTE:**

- IT IS ESSENTIAL TO FIT A WATERPROOFING STRIP OF THE CORRECT WIDTH FOR THE ROOFING.
- THE INCLINED BATTEN AND THE BATTENS SUPPORTING THE WATERPROOFING STRIP MUST BE AT LEAST 5MM THICKER THAN THE BATTENS SUPPORTING THE FRAMES. THE USE OF AN 18MM THICK COUNTERPLATE IS IDEAL IN MOST CASES.

1 Cut the sealing strip to the correct length of the PV array, adding 20cm on either side of the array (see diagram above).

2 Fold the top and sides **by around 20 mm** to prevent any water rising up.



3 Remove the plastic film strip and stick it to the support battens in accordance to the manufacturer instruction.

**On wet battens, don't hesitate to hold it at its upper lip, using fixing hooks.**

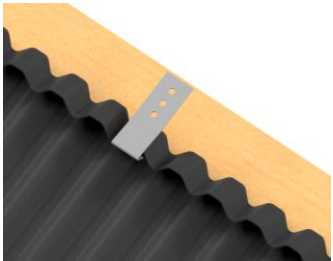

4 Stick it to the tiles. Make sure you press it firmly into place so that it follows the shape of the tile in accordance to the manufacturer instruction.

**Installation on all roofing elements (except deep -curve tiles)**

- 1 Make the right angle of the semi-rigid flashing. Bend the right-hand edge of the flashing (2cm) with folding pliers to create a clamp and a lateral water barrier. Flatten the clamp so that it is not completely stuck to the flat part of the flashing, but at 2mm-3mm.

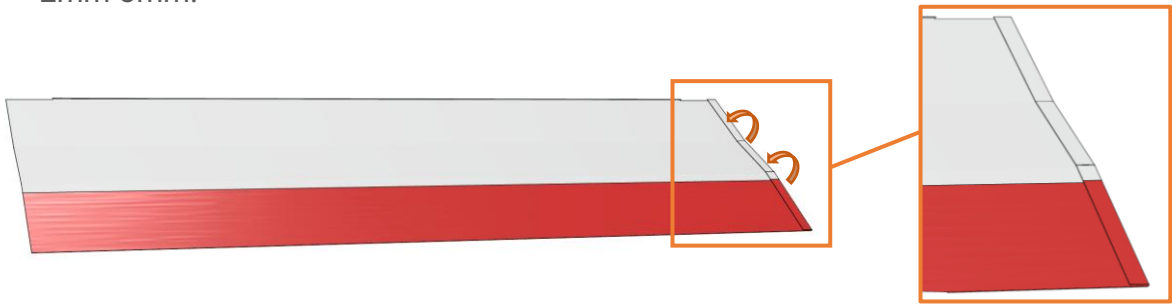

- 2** Position the right angle created earlier at the lower right end of the PV field. Position the semi-rigid flashing from right to left, fixing them to the thickness of the support battens at their fixing lugs. Place the flashings side by side until the top clips touch, then stick the flexible parts together. The overlap between 2 flashings is 170 mm.

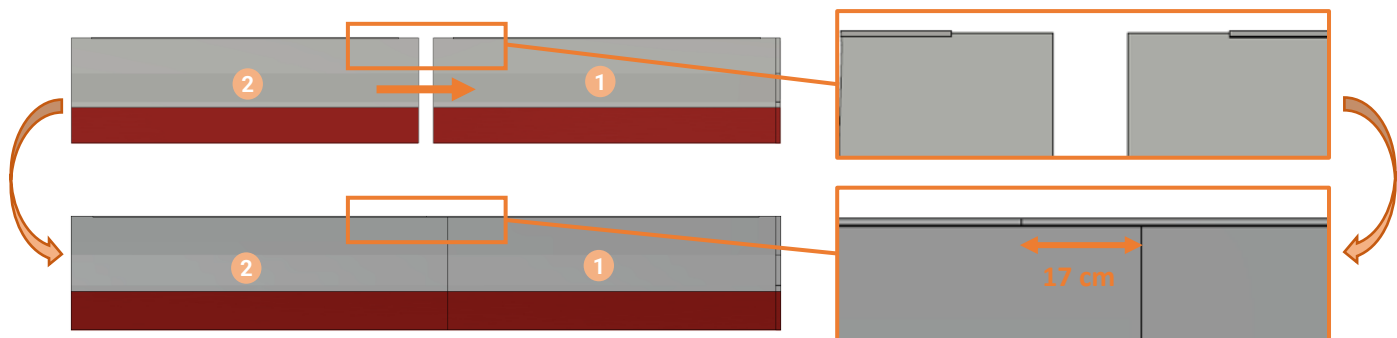
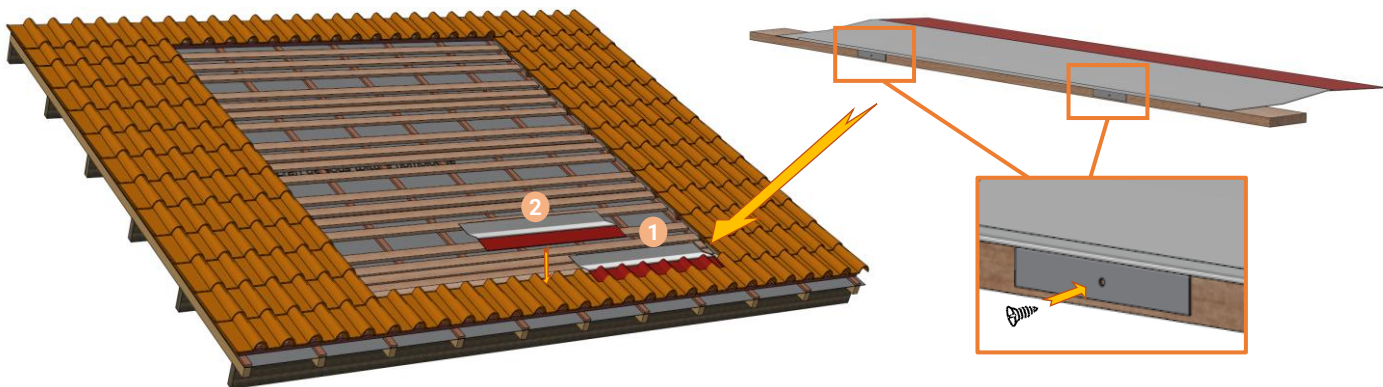



- 3 Create the left-hand corner. To do this, cut the flashing at the left end of the field to the required length. Make a 2cm fold at the left side to create a lateral water barrier.

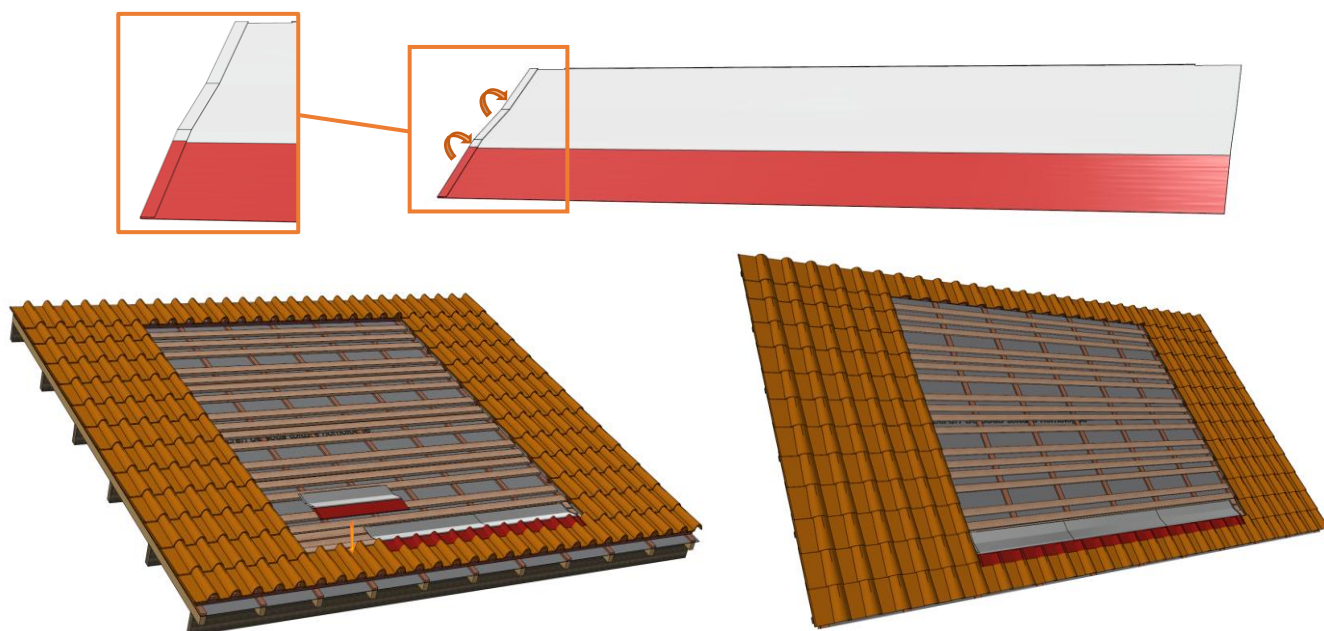

- 4 Remove the plastic film under the waterproofing strip, and stick it to the tile. It's highly recommended to use a roller to smooth the product on the tile.

### 3.3.2 Connection to the gutter

**For installation right up to the lower edge of the roof,** we recommend that the PV field-gutter connection is made using 2 drip flashings: 1 drip flashing for the PV field and a 2<sup>ème</sup> drip flashing for the roof membrane. This is to allow the condensation water created on the roof membrane to drain into the gutter.

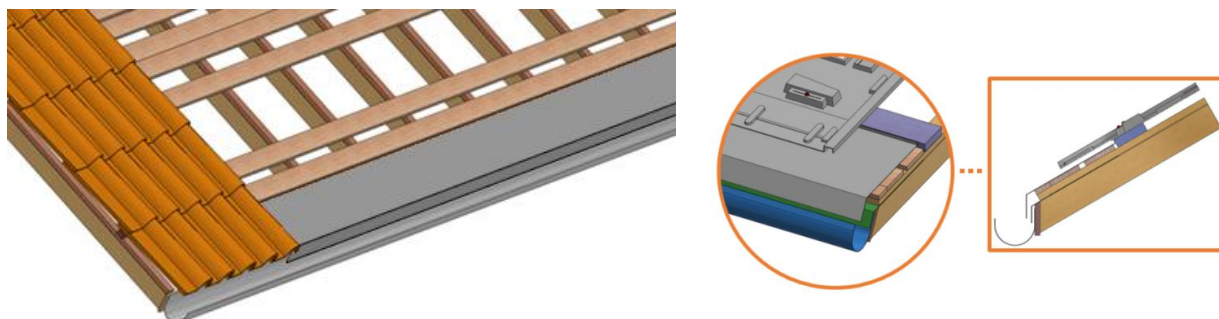

### 3.4 GSE Portrait half-frames and frames installation

#### 3.4.1 Installation of Portrait Evolution half-frames

Portrait half-frames are laid line by line, from right to left and from bottom to top.

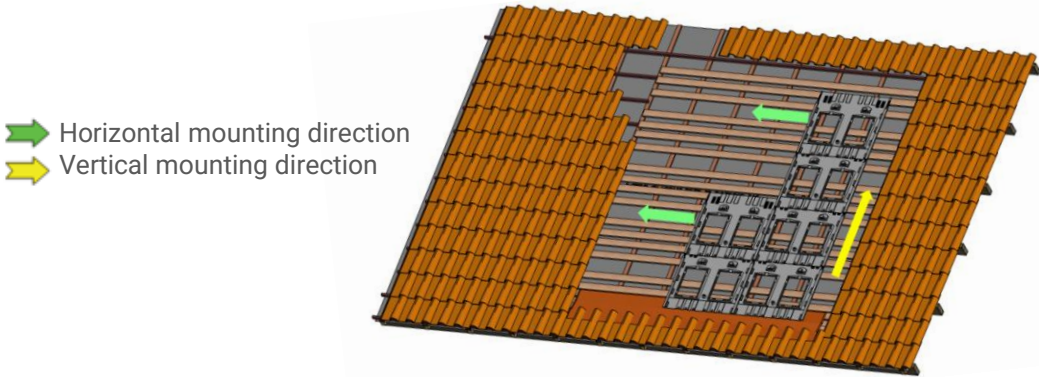

- 1 Position the 1<sup>st</sup> frame at the bottom right of the PV field. Position it **vertically in relation to the reference batten** (the bottom of the frame must be 255mm from the top of the reference batten). Position it **horizontally 20cm from the edge of the batten** and/or from the **minimum 9cm overlap of the tiles on the flashing** (which will be placed on the frame's corrugation in the next step). Make sure it is straight.

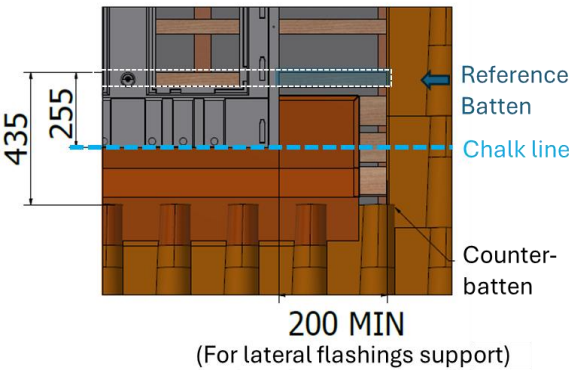

- 2 Fix the 1<sup>st</sup> frame at its 3 fixing points: its central fixing point (red) and the 2 other pre-drilled fixing points (yellow).

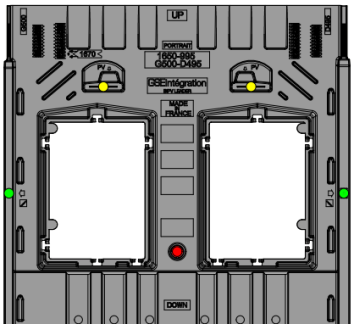

Assemble the other half-frames of the 1<sup>st</sup> line of the frame array horizontally, using the external lug of the Portrait half-frames. Fix them at their 3 fixing points.

3

You can align the bottom of the first row to a chalk line, positioning it at 280 mm from the reference batten. To do this, make sure the sealing strip is stable and fixed.

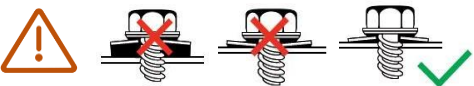

Be careful not to press the screws too far into the

- 4
- Assemble the half-frames of the upper lines to the correct graduation according to the length of PV module to be installed. Fix them at their 3 fixing points.







**CAUTION:** THE SCREW LENGTH CAN BE REDUCED TO 45MM FOR THE FRAME FIXING POINTS IF, AND ONLY IF, THE SUBSTRUCTURE DOES NOT INCLUDE COUNTER-BATTENS.

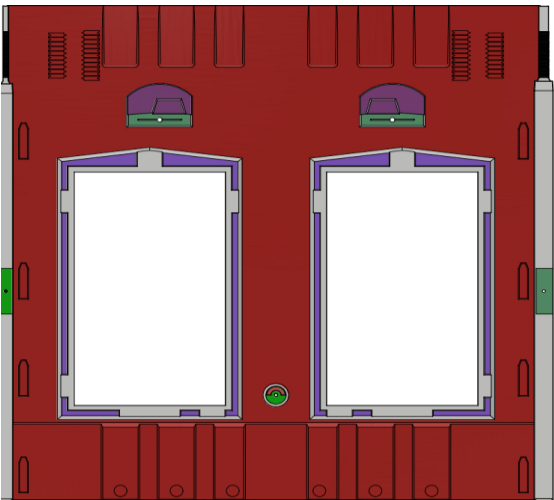

**Reminder:** It is forbidden to drill in the drainage areas and on the high points of the GSE half-frame, as this could damage the integration of the photovoltaic system and its watertightness.

Refer to drawings p.7 and 31 for frame fixing locations.



-  Outflow zone  
**Drilling prohibited**
-  Highest zones  
**Drilling prohibited**
-  Fastening zones  
**Drilling authorised**

**Never pierce  
water run-off areas**

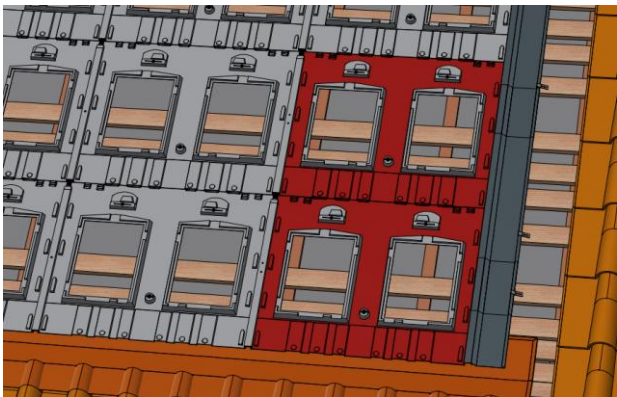

### 3.4.2 Installation of Portrait Full frames

Like half-frames, Portrait frames are laid line by line, from right to left and from bottom to top.

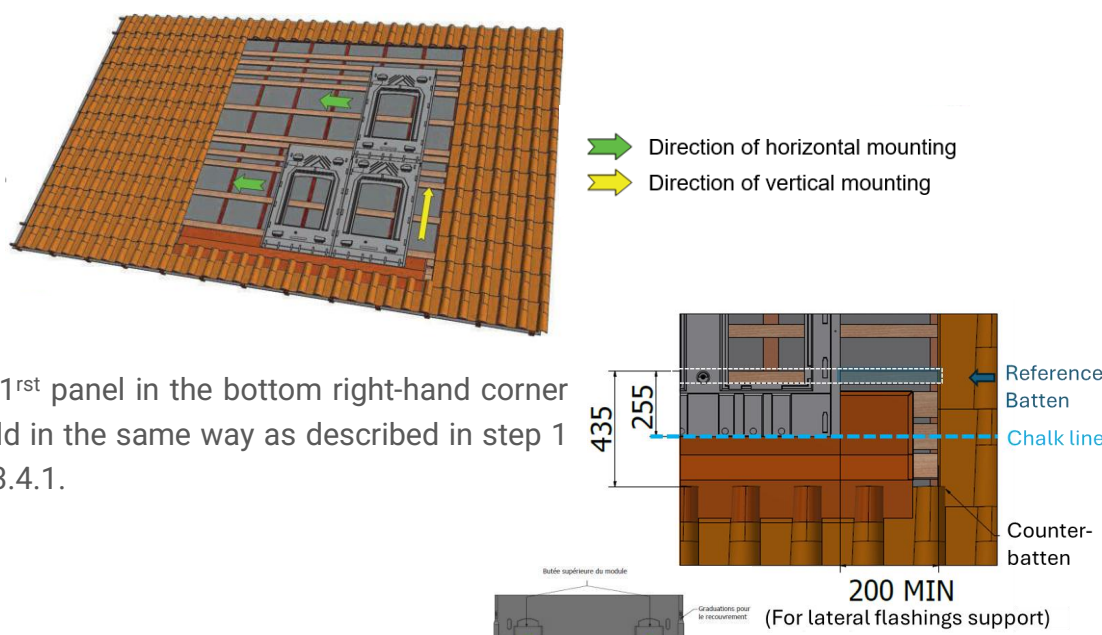

- 1
- Position the 1<sup>st</sup> panel in the bottom right-hand corner of the PV field in the same way as described in step 1 of paragraph 3.4.1.

Fix the 1<sup>st</sup> frame at its 2 central fixing points (red), by screwing the screws directly into the frame (without pre-drilling).

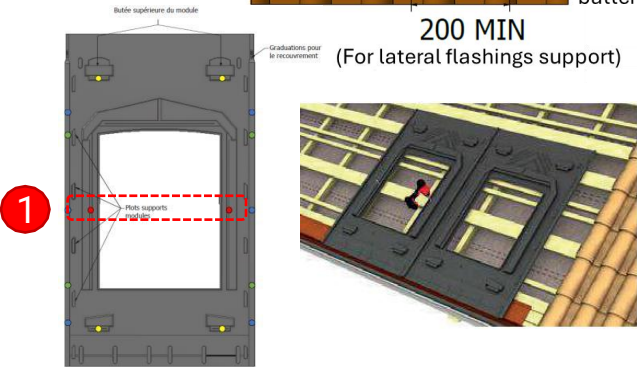

**CAUTION: THE SCREW LENGTH CAN BE REDUCED TO 45MM AT THE PLATE FIXING POINTS IF, AND ONLY IF, THE SUBSTRUCTURE DOES NOT INCLUDE COUNTER-BATTENS. OTHERWISE, YOU MUST USE THE STANDARD GSE SCREW LENGTH OF 60MM WITH THE IN-ROOF SYSTEM.**

- 3
- Assemble the other frames of the 1<sup>st</sup> line of the frame array by fitting the right-hand corrugations onto the left-hand corrugations and fixing them at their central fixing points. Adjust the second line of plates to the correct graduation, depending on the length of PV module to be installed (graduation annotated on the frame every 5mm up to 40mm, from 40mm measure with a measuring tape the additional adjustment required, up to 100mm).





4 Pre-drill the remaining 4 fixing points of the GSE frame with a 10 mm drill bit (the v.2022 half-frames are already pre-drilled to 10 mm on the support pads).

**TIP:** It is possible to pre-drill the yellow points in the frame before fitting it to the roof. The frames should be drilled individually (do not drill several frames at the same time).

Pre-drill

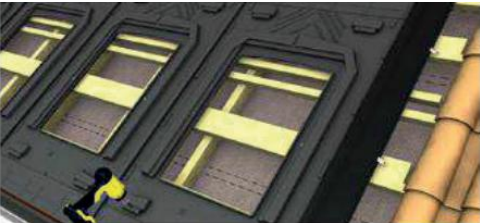

Screw

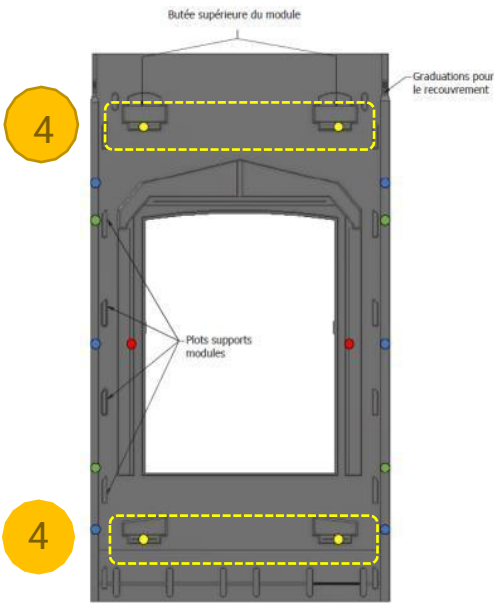

The screw length can be reduced to 45mm at the plate fixing points if and only if the substructure does not include counter-battens.



**Reminder:** It is forbidden to drill in the drainage areas and on the high points of the GSE frame, as this could damage the integration of the photovoltaic system and its watertightness.

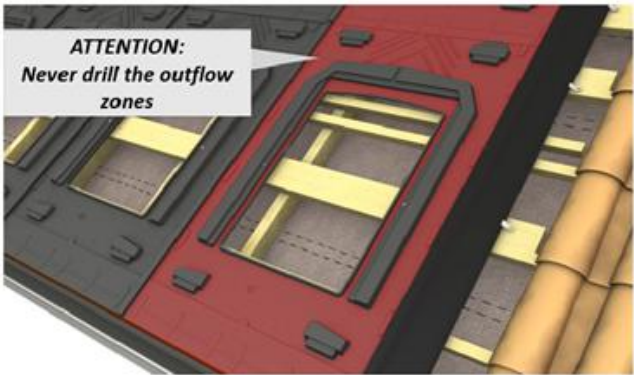

### 3.5 OPTIONAL STEP - Installation of the microinverters and their cabling

EXAMPLE OF AN ELECTRICAL DIAGRAM FOR AN INSTALLATION WITH MICROINVERTERS :

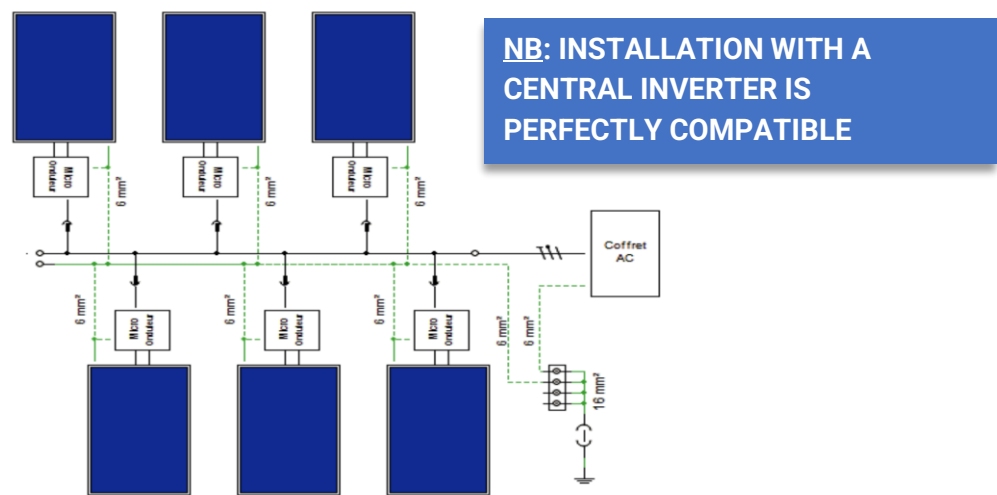

- 1 If using micro-inverters, attach them to a batten in the centre holes of the Portrait Evolution half-frame.



- 2 Connect them together using connection cables, which you will need to run under the half-frames.



**CAUTION:** REFER TO THE INVERTER INSTALLATION MANUAL AND ENSURE THAT THE INSTALLATION COMPLIES WITH THE MANUFACTURER'S RECOMMENDATIONS.

✓ Validated compatibility with all microinverters and optimisers on the market

### 3.6 Lateral flashings installation

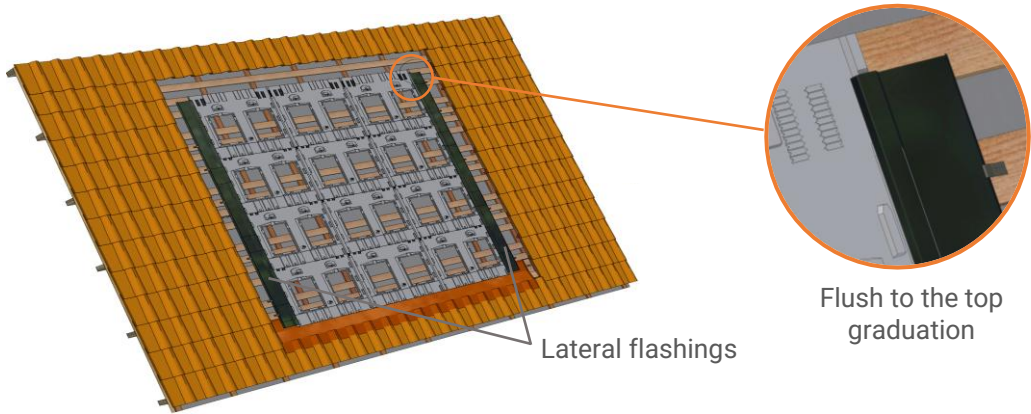

**WARNING:** BEFORE INSTALLING THE LATERAL FLASHINGS, MAKE SURE TO PLACE THE WEDGES AT THE ARRAY ENDS, UNDER THE CORRUGATIONS, WHERE THE END CLAMPS ARE LOCATED.

- 1 Place the wedges under the corrugations at the ends of the PV field (which are not interlocked with another corrugation), where the clamps will be.

→ Position the **R (Right)** wedges under the corrugations at the right-hand end of the PV field.

→ Position the **L (Left)** wedges under the corrugations at the left end of the PV field.

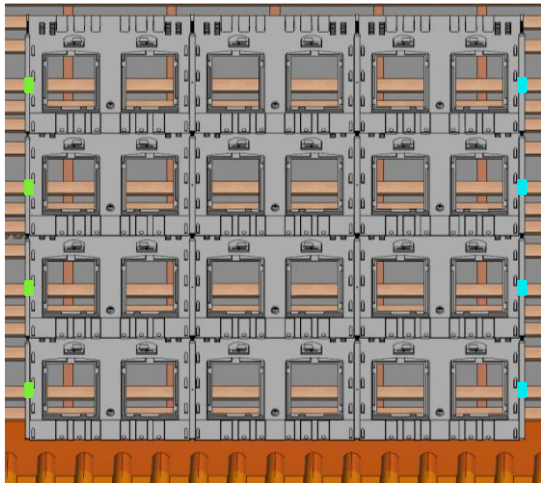
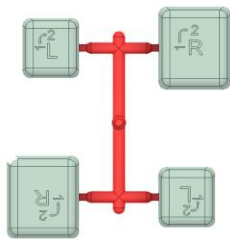

→ Turn the wedges **to position 1** to clip them into the corrugations of the Portrait Evolution Half-Frames.

→ Turn the wedges **to position 2** to clip them into the corrugations of the Portrait Full Frames.

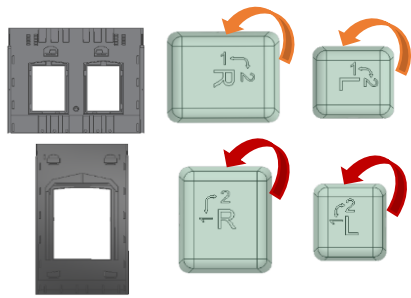

**For Portrait Full Frames:** Mark the position of the wedges on the inside surface of the frame so that they can be located after the lateral flashings have been positioned.

- 2 Position the lateral flashings from the bottom end of the first row of frames, up to the last graduation of the top edge row of frames. There should be a minimum overlap of 150mm between two pieces of lateral flashings. Each shall be held in place by at least 2 fixing hooks.

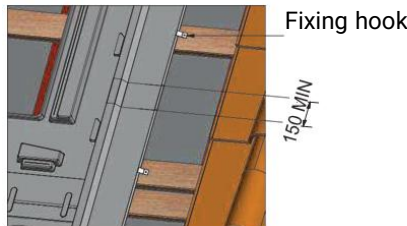



- 4 Use a 10 mm drill bit to pre-drill the fixing points for the clamps.

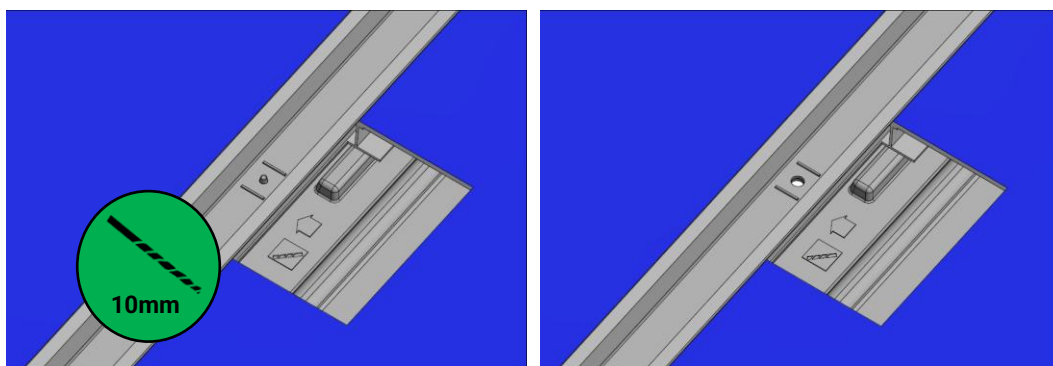
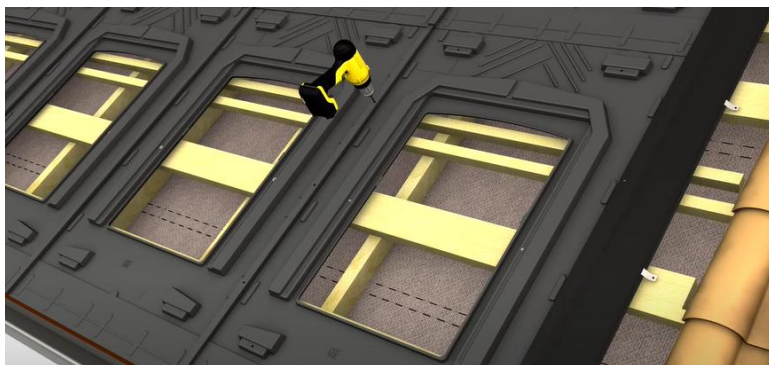

- 5 For end clamps, pre-drill through the flashing, the frame corrugation and the wedge.

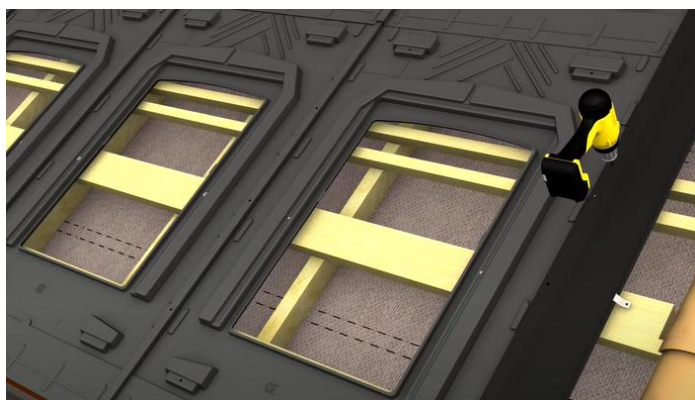

### 3.7 OPTIONAL STEP - Intermodule flashings installation

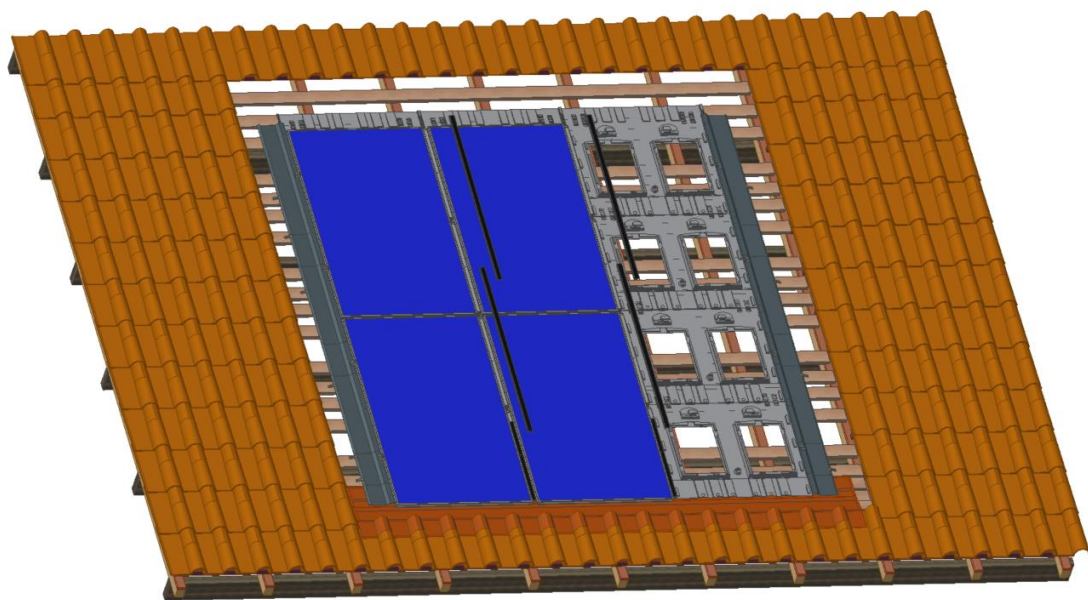

Place the **inter-column flashings** from bottom to top on the corrugations of the frames, so that the overlap between 2 flashings is at least 150mm.

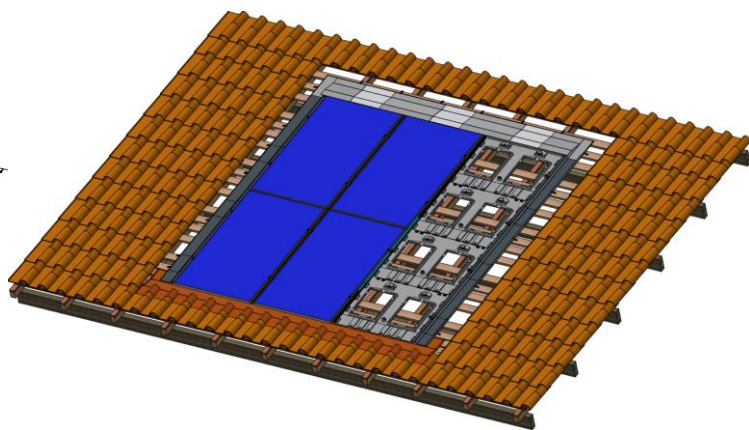
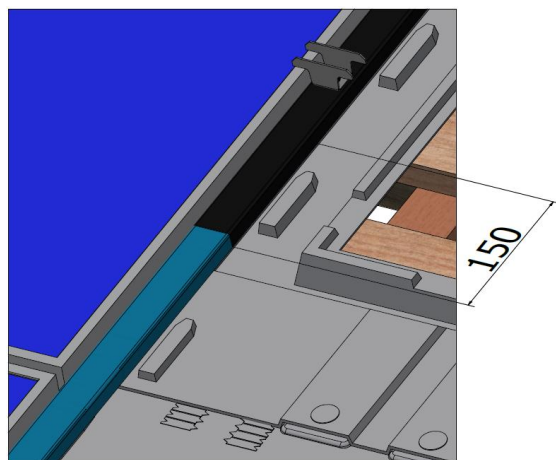

You can add a sewing screw to the corrugations to hold them in position. To do this, make sure:

- To not position it on an overlap between 2 intermodule flashings
- Use a 10mm drill bit to pre-drill the location of the sewing screw

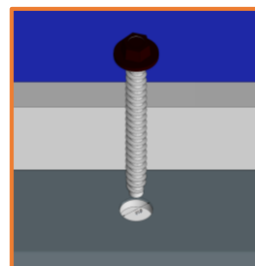

### 3.8 PV modules installation

#### 3.8.1 Laying the modules on the frame's support pads

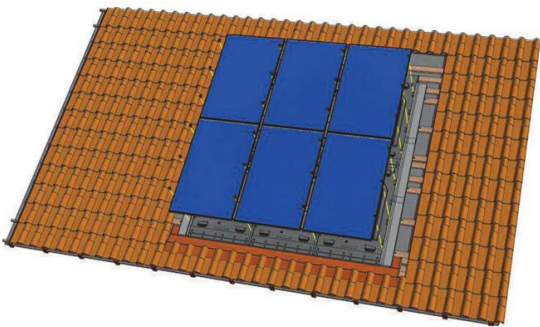

Position the module so that the cables from the junction box pass through the space provided.

**TIP:** Some module manufacturers allow portrait installation with the single junction box facing downwards; please refer to the manufacturer's instructions.

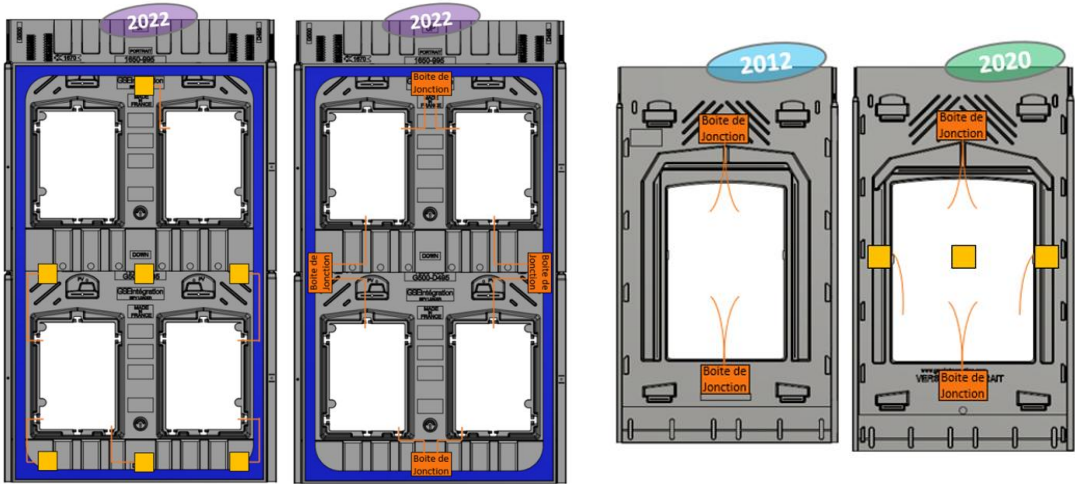

- 1 Position the modules so that they rest on the support pads and abut the top protrusions (orange arrows).

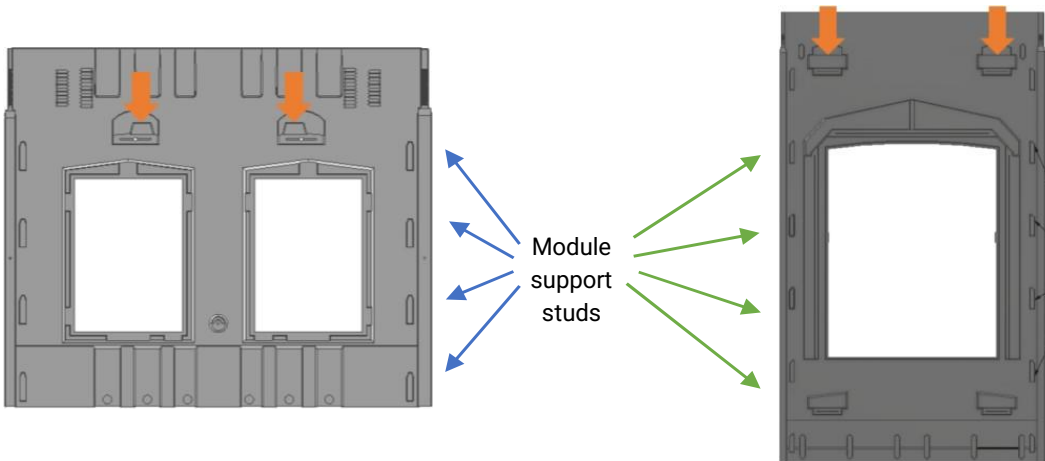





**WARNING:** ALWAYS ENSURE THAT THE MODULES ARE CENTRED IN THE FRAMES. THE FRAME OF THE PV MODULE MUST COME UP AGAINST THE TOP PADS OF THE FRAME TO PREVENT SLIPPING.

## 2 Wiring and Grounding

- **Ground** each module frame and the microinverters via the slot provided or via a grounding clamp. Please refer to the manufacturers' installation instructions.

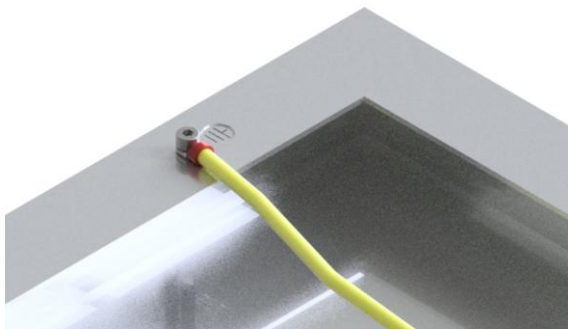

Make sure you run the earthing cables under the half-frames, using the clips in the central windows.



**CAUTION:** WHEN SETTING UP THE CABLES, TAKE CARE NOT TO CREATE ANY INDUCTION LOOPS, IN ACCORDANCE WITH UTE C15-712 GUIDES.

- To **connect the PV modules to each other or to the microinverters** installed in one of the central windows of a Portrait frame, be sure to pass the cables under the frames via the clips in the central windows.

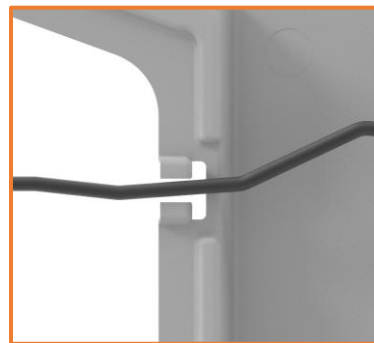

### 3.8.2 Fixing the clamps

- 3 Fix the PV modules by screwing the clamps into the pre-drilled holes (with watertight GSE screws).

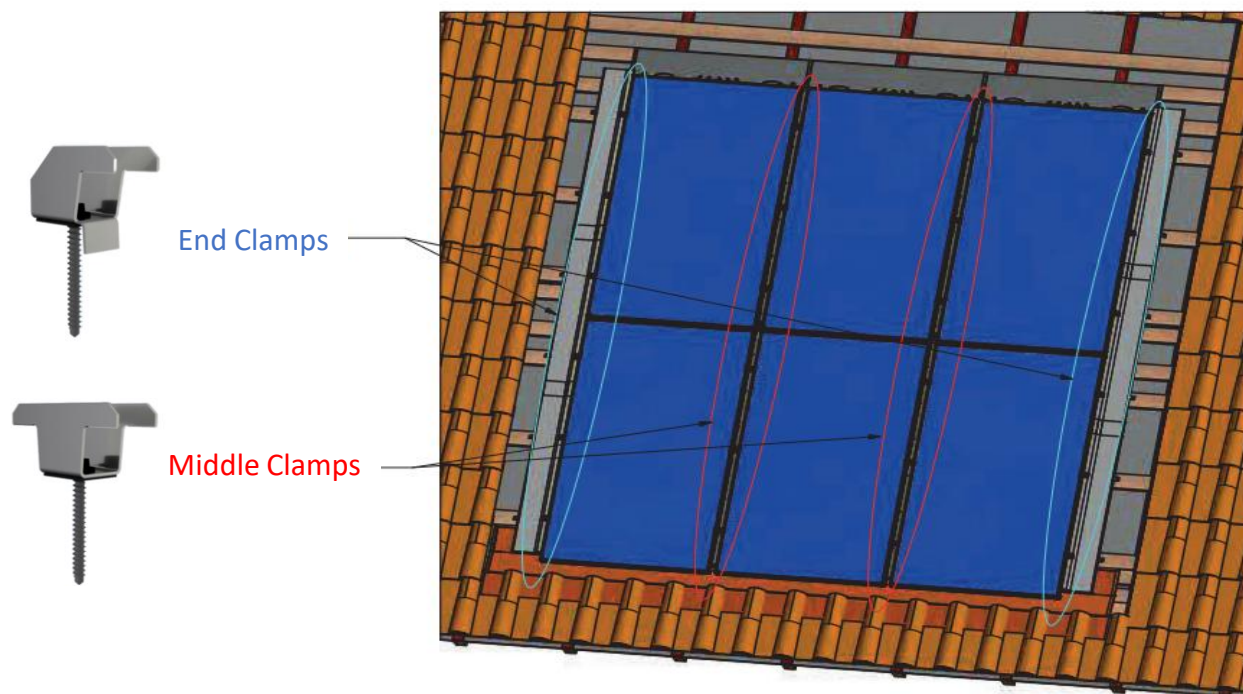
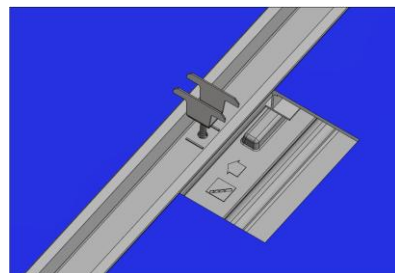

**DO NOT USE AN IMPACT SCREWDRIVER TO FASTEN THE CLAMPS. IT IS IMPERATIVE TO USE A NORMAL SCREWDRIVER TO ENSURE THAT THE CLAMPS STAY IN PLACE OVER TIME.**

### 3.9 Installation of the top PV field connection

#### 3.9.1) OPTION 1 - Top flashings installation

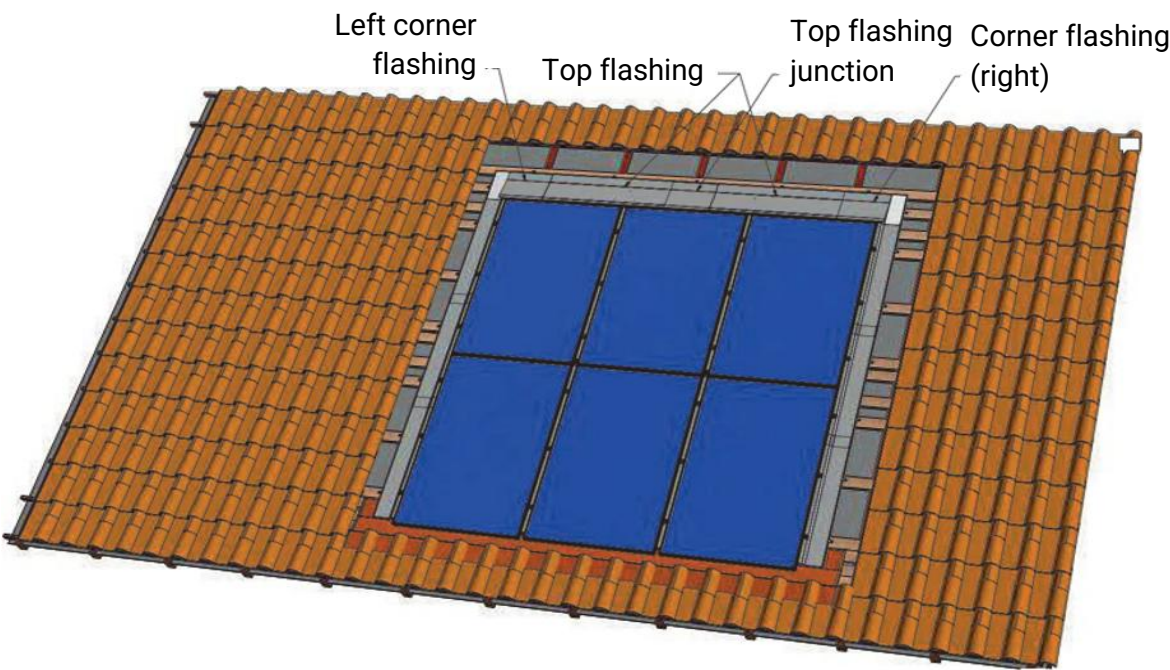

**WARNING:** THE TOP FLASHING PIECE IS DESIGNED WITH A SLOPE OF 14° TO ALLOW WATER FLOW ABOVE THE UPPER ROW OF MODULES. IT IS THEREFORE, ESSENTIAL FOR THE INSTALLER TO ENSURE THAT THE ROOF SLOPE IS SUFFICIENT TO PREVENT WATER RETENTION ACCORDING TO THE REGULATION.

IN BORDERLINE CASES, WE RECOMMEND THAT YOU EITHER USE A THICKER SUPPORT LATH TO DECREASE THE COUNTER-SLOPE OR TO REPLACE THE TOP FLASHINGS WITH A FLEXIBLE FLASHING STRIP (SEE PAGE 34).

- 1
- Join the top flashings and the attach angle using pop rivets, taking care that you adjust the module frame thickness.

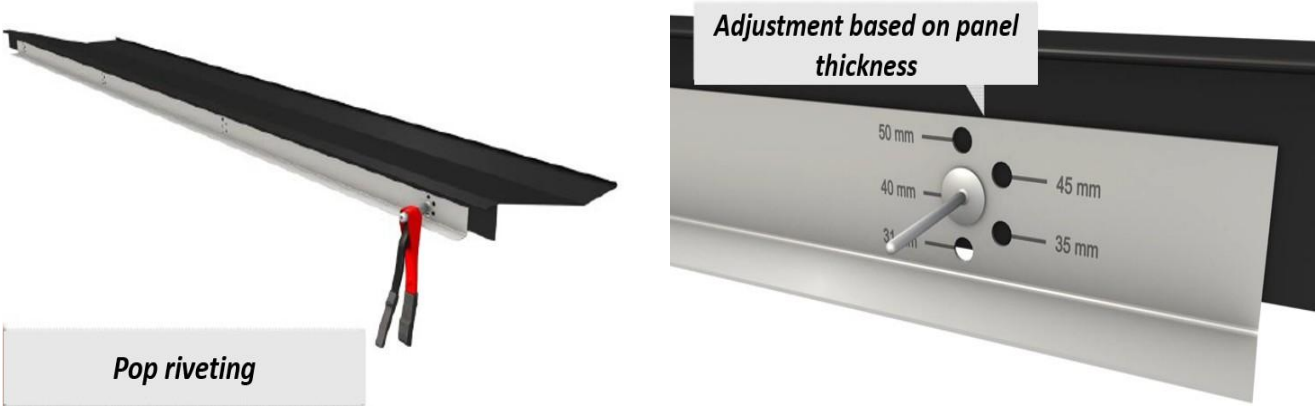



- 2 Position the assembly so that the module frame thickness fits in between the attach angle and the top flashing.

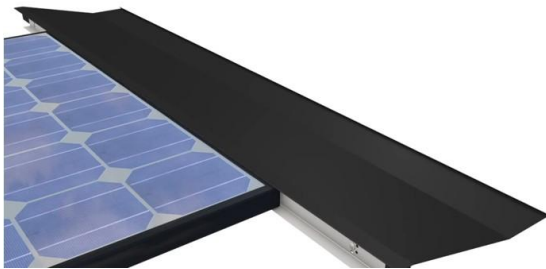

Make cuts on the attach angle at the position of the GSE panel corrugations.



Cut on the attach angle

- 3 Place the top junction flashing, having applied beforehand two PU glue joints on the covered top flashing area. The connecting piece must overlap with the top flashing with at least 100 mm. The gap between the top flashings should not exceed 160 mm.

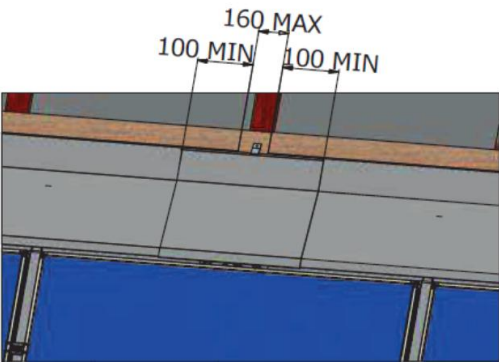
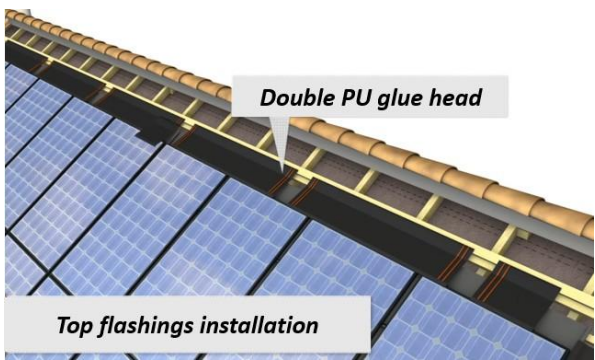

- 4 In the same way, place the corner flashings, having applied beforehand a PU glue joint on the overlapping zone of the top flashing. (Overlapping at least 100mm)

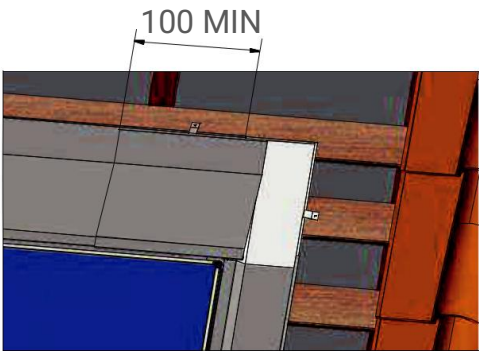
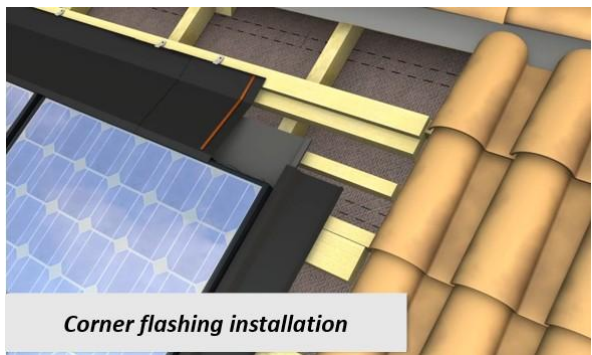

- 5 Fix all flashings to the battens using flashing hooks (at least 2 per piece).

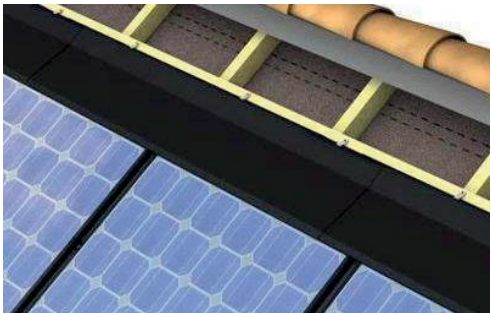





**SPECIFIC CASE:** if a gap is observed between the module and the corner flashing, cut it in order to adapt it to the thickness of the module.

Module thickness	30-34 mm	35-39mm	40 and +
Frames 2012	Incompatible*	Needed cut	No cut needed
Frames 2020	Needed cut	No cut needed	Incompatible*
Half-frames 2022	Needed cut	No cut needed	Incompatible*

\* Laying of a waterproofing strip on top of the PV field

GSE frames - PORTRAIT																			
	Frames v.2012							Frames v.2020											
Height Ref	1580	1575	1575	1575	1640	1640	1686	1710	1710	1710	1710	1710	1710	1710	1710	1710	1710	1710	
Width Ref	808	1046	1053	1082	992	1001	1016	995	1000	1005	1010	1020	1025	1030	1040	1045	1050	1055	

Half-Frames GSE In-Roof v.2022 - PORTRAIT																					
Height Ref	1650	1650	1650	1650	1650	1650	1650	1840	1840	1840	1840	1840	1840	1840	1840	1840	1840	2030	2030	2030	2030
Width Ref	995	1070	1100	1135	1140	1145	1160	995	1020	1030	1040	1045	1050	1070	1090	1100	1135	995	1050	1055	1135

Follow the 4 steps below to cut the corner flashings

1

2

3

4

Cut the corner flashing in two distinct pieces

Once the height adjusted, drill the overlapped pieces with a 4,5mm drill bit

Assemble the pieces with a rivet

Once the adjustment of both corner flashings is done, install them as described in steps 4 & 5, page 38.

### 3.9.2) OPTION 2 – Top sealing strip & Tile support installation

#### 3.9.2.1 Top waterproofing strip installation

It is possible to use a flexible waterproofing strip of minimum 300mm width to connect the PV field to the roof at the top.

To do this, make sure to fold the strip at the top and sides over a distance of 2cm, to prevent any water rising up.

Remove the plastic film from the small butyl strip and stick it to the top battens. Remove the plastic film from the wide butyl strip and stick it to the frames. Smooth the waterproofing strip on the battens and the frames.

Make sure to have a minimum overlap of 10cm under the tiles.

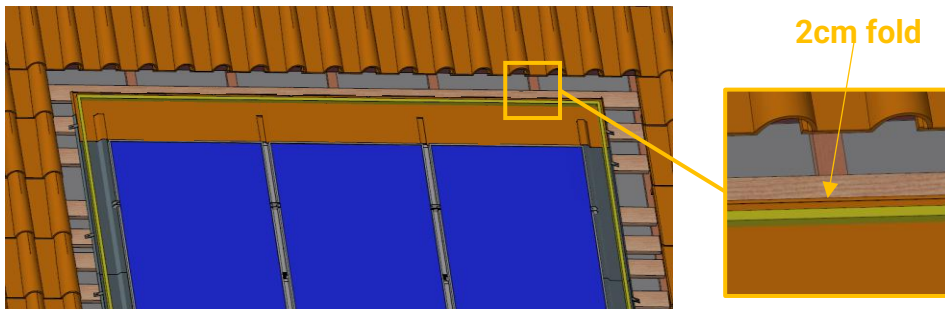

#### 3.9.2.2 Tile support installation

For all tile installations (except slate) on a waterproofing strip, you can add a tile support to prevent the tiles from sagging on the strip. To do this, slide 2 long fixing hooks into the triangular supports and fix them with nails and/or screws to the top batten used to support the top connection.

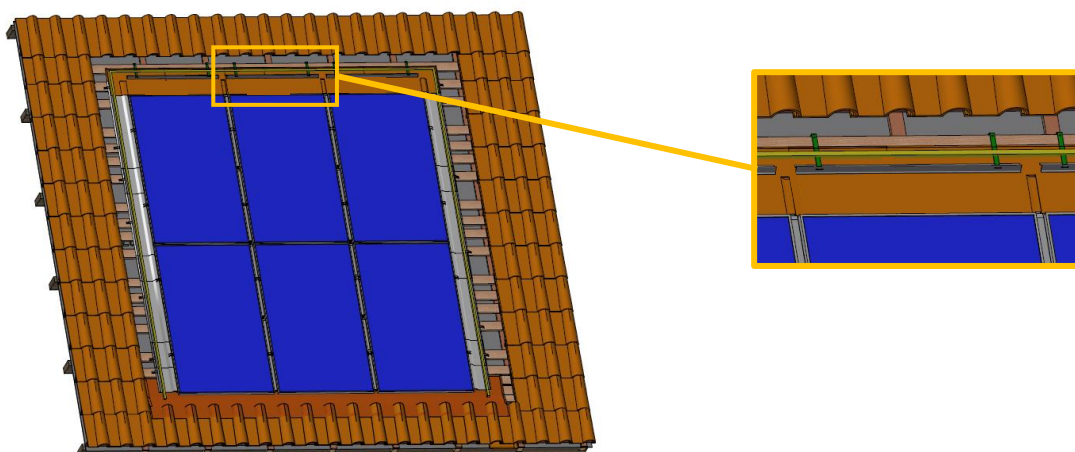

### 3.10 Connection to the roof covering

- 1
- Place the precompressed seal on the flashings all around the PV array on the lateral and upper flashings.

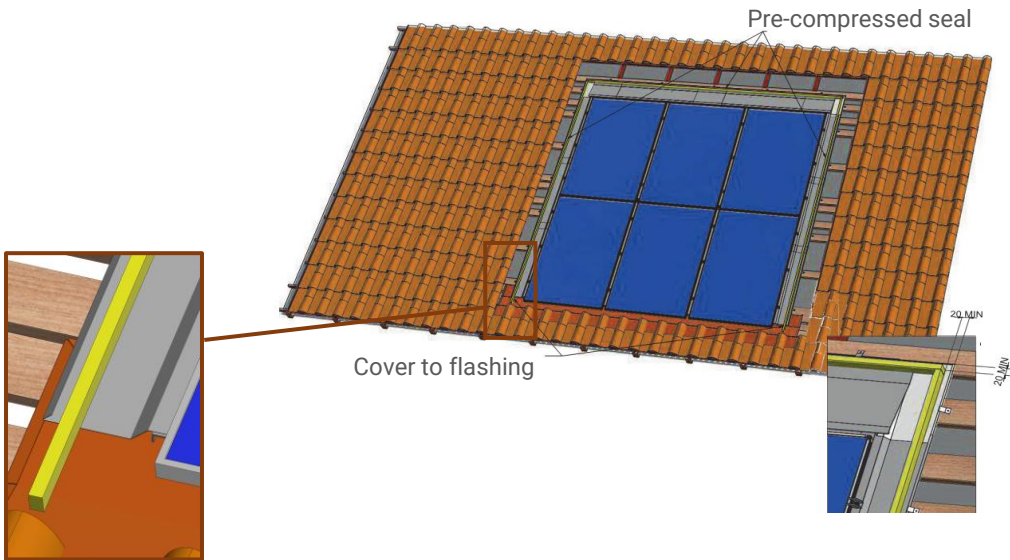

The seal must reach the bottom of the flexible flashing strip to prevent any potential infiltration of water or solid particles.

- 2
- Reposition the lateral and upper sections of the roofing elements to make a continuous and watertight connection with the roof.

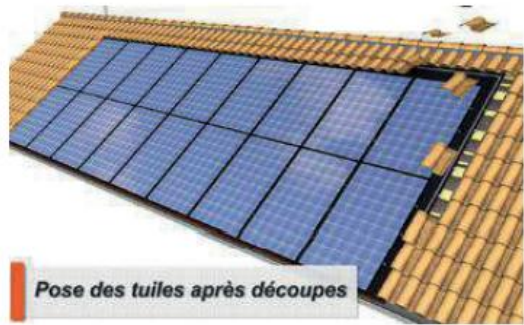

It may be necessary to cut the tiles to ensure a compliant overlap between the elements, according to roofing regulation. These elements must be attached mechanically, as described in the roofing regulation.



Tiles cut for left-hand side connection



Tiles cut for top connection



Double tiles or half tiles can be used for the side connection.

The roof tiles must rest on the flashings with enough overlap to meet the requirements of the roofing regulation.

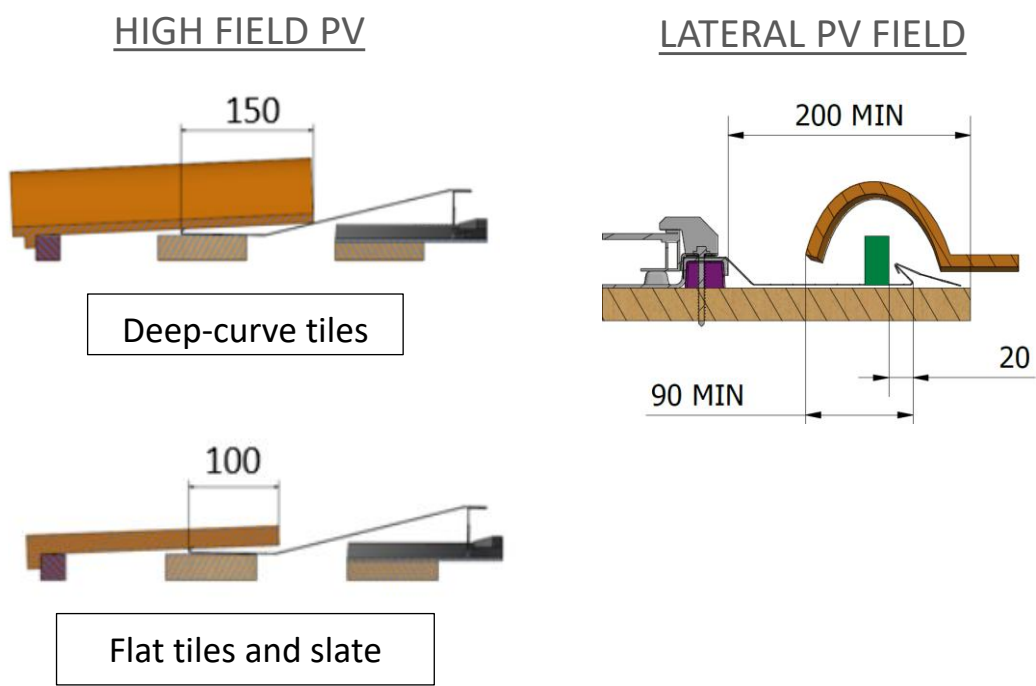

### 3.11 Specific case: PV array inner/outer angles

In the case of non-rectangular PV array, inner and outer angles must be connected to the roofing using a flexible flashing strip compliant with the building/roofing regulation.

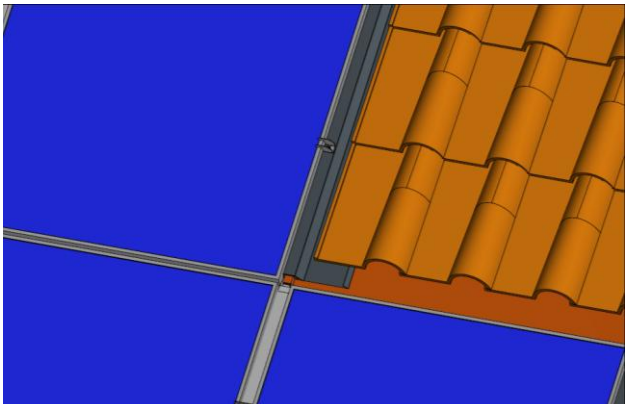

Special case: inner angle

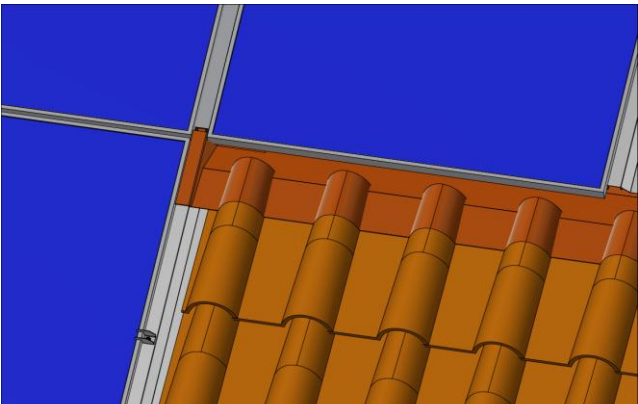

Special case: outer angle



### 3.11.1 Inner angle ("L" shape)

Place the flashing strip by covering the lower-row frames up to the corrugation of the adjacent frame, then cover the strip with the lateral flashing.

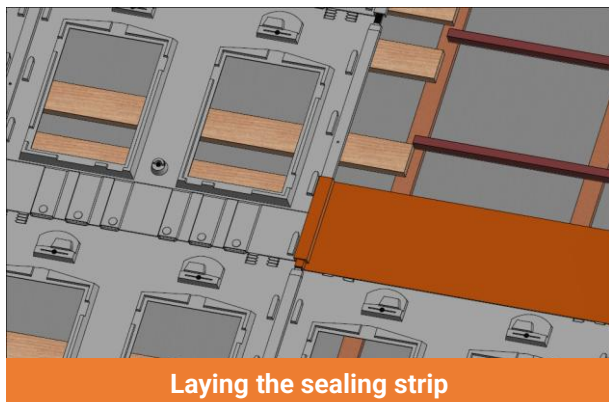

Laying the sealing strip

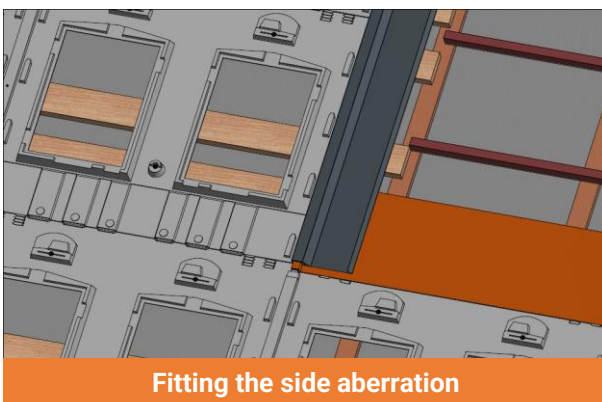

Fitting the side aberration

### 3.11.2 Outer angle ("T" shape)

Place the lateral flashing on the lower-row panel. Reposition the adjacent tiles to cover the lateral flashing, then place the flashing strip so that it overlaps with the last row of tiles, ensuring that there is a 2-cm fold in the upper section.

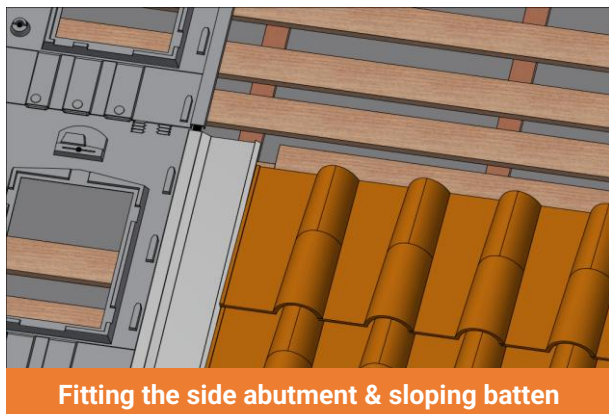

Fitting the side abutment & sloping batten

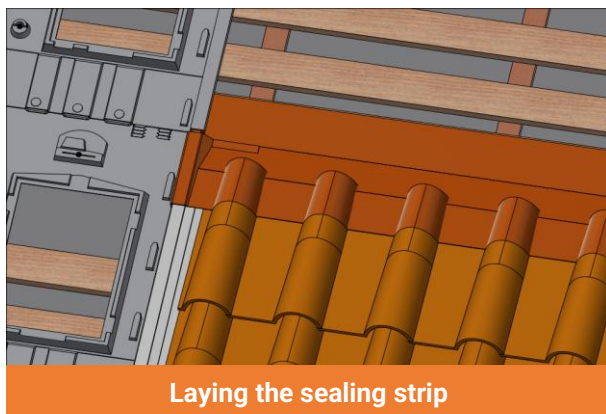

Laying the sealing strip

Place the half-frame on the sealing strip, following the installation instructions on page 31.



**ATTENTION:** Make sure you have the right spacing between the bottom of the plate and the tiles to allow the PV module to protrude.

Be sure to comply with the covering rules in the relevant DTU roofing standard and the recommendations in paragraph 3.2.2 of this document.

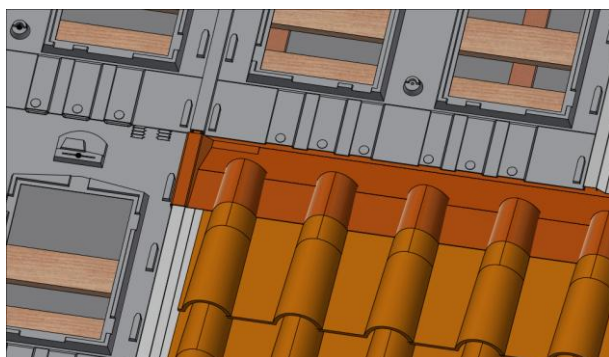

## 4. Maintenance and servicing

### 4.1 Verification



It is important to check once a year whether leaves and/or other foreign materials have got under the photovoltaic array or between the panels. You can use a compressed air blower to remove any items that have got under the photovoltaic array. Do not use solvents to clean the polypropylene frames.



For prevention, we also recommend that overall PV system installed is checked occasionally.

### 4.2 Module replacement

Disconnect the PV array from the AC box and proceed as follows:

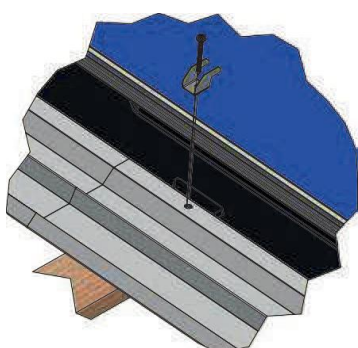

1. Unscrew the fixing clamp, remove the module and remove the edge wedges.



2. Screw one GSE screw at the location of old hole, having placed beforehand a new polypropylene edge wedges under the corrugation if it is located on an array edge.



3. Make a new 10 mm hole, 25 mm above the old position.

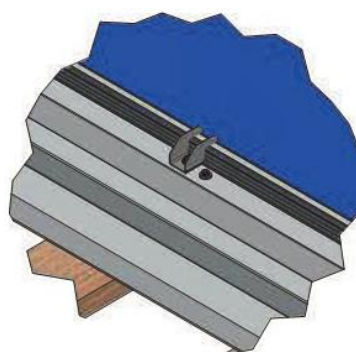

4. Place the module and attach the new assemblies (fixing clamp + EPDM foam + GSE screw).



## 5. Support and Contact

### 5.1 Training sessions

The GSE Integration team offers technical training sessions on the product with practical application on a demonstration model on your request and subject to the presence of a sufficient number of participants.

For further information, please contact your sales manager or distributor.



### 5.2 Technical assistance

TECHNICAL ASSISTANCE IS AVAILABLE  
MONDAY TO FRIDAY  
FROM 9H30 TO 18H



5 rue Morand  
93400 SAINT OUEN (France)  
E-Mail: [contact@gseintegration.com](mailto:contact@gseintegration.com)

## 6. Certifications and guarantees

### 6.1 Technical assessments

ETN n°A27T2021000B0

ALPES

CONTRÔLES

Technical Notice n°21-16/57 - "[Solar Roof](#)" product

CC

FAT

AVIS

MCS 012 - KIWA00041

MCS

### 6.2 Fire tests

BRoof T1

Broof T2

Broof T3

Broof T4



















warrington

fire

### 6.3 Guarantees

Our systems are guaranteed for 10 years if they are installed in accordance with this manual and our certifications. Please refer to our General Terms and Conditions for more details, available on the Connector tool - 'document' section.

# GSE

Intégration

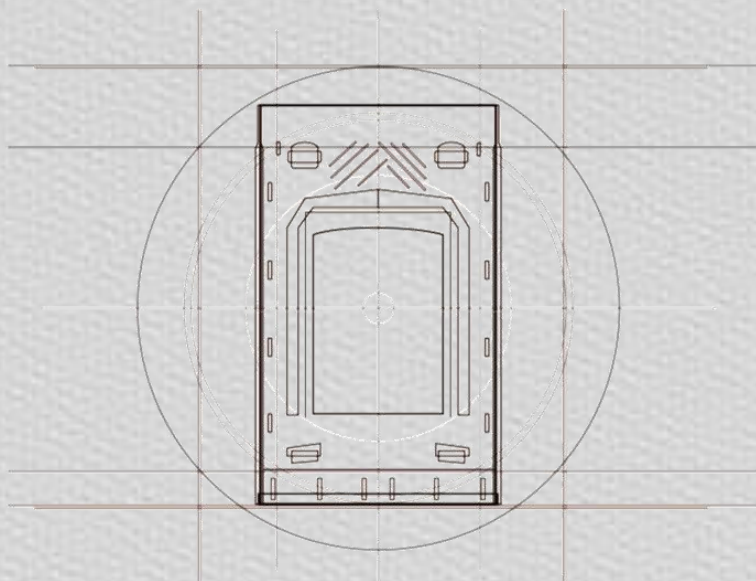

## GSE **IN-ROOF SYSTEM**™

*Photovoltaic panel mounting system  
integrated into the roof*

**GSE**  
Intégration

---

Your distributor: