

Easee Base

Easee Base is a robust and weatherproof post that gives you more freedom to install the Charging Robot where it suits you best. It has four configurations that support single, dual, triple and quad charger setups, getting the maximum out of the installation. Thanks to its Power Rail connection box, it connects different posts in series, while converging all Charging Robots terminations in the same rail.

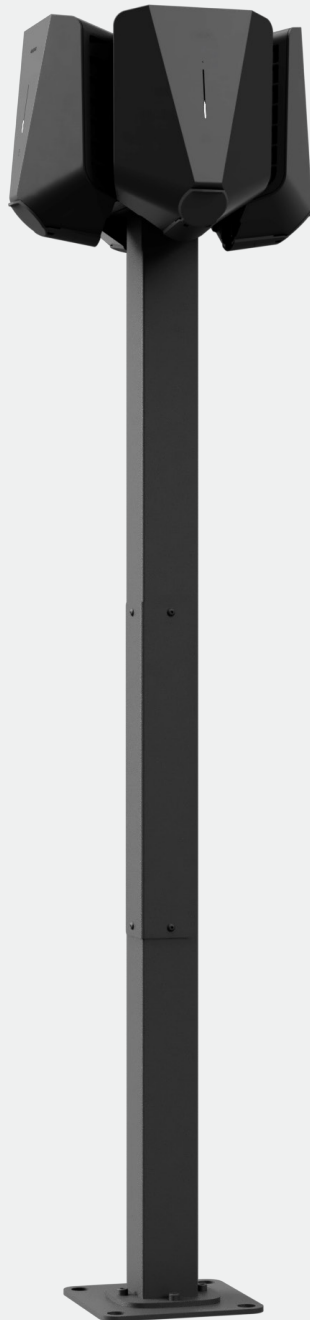

Why choose Easee Base?

Benefits

- Up to four Easee Charging Robots can be installed on the same post.
- Easy to connect each post in series with the supplied Power Rail connection box.
- Made of aluminium and stainless steel, with a strong scratch resistant powder coating, ensuring a long lasting durability.
- Integrated cable hooks that allow the charging cable to be permanently connected¹
- Adapter plate that allows for a 45 degree installation angle.
- Designed in Norway

¹Only available for 1-way and 2-way setups. The charging cable can be permanently locked in the Charging Robot.



Power Rail

The Power Rail is an optional connection box that allows multiple charging posts to be connected in series.

We recommend using the two upper terminal sets for the charger cables. For a single charger, only one set of terminals is used, for two chargers both sets of terminals are used and for three or four chargers two wires have to share a terminal.

The two lower sets of terminals are used for power in and out.



Specifications

Measurement
in mm

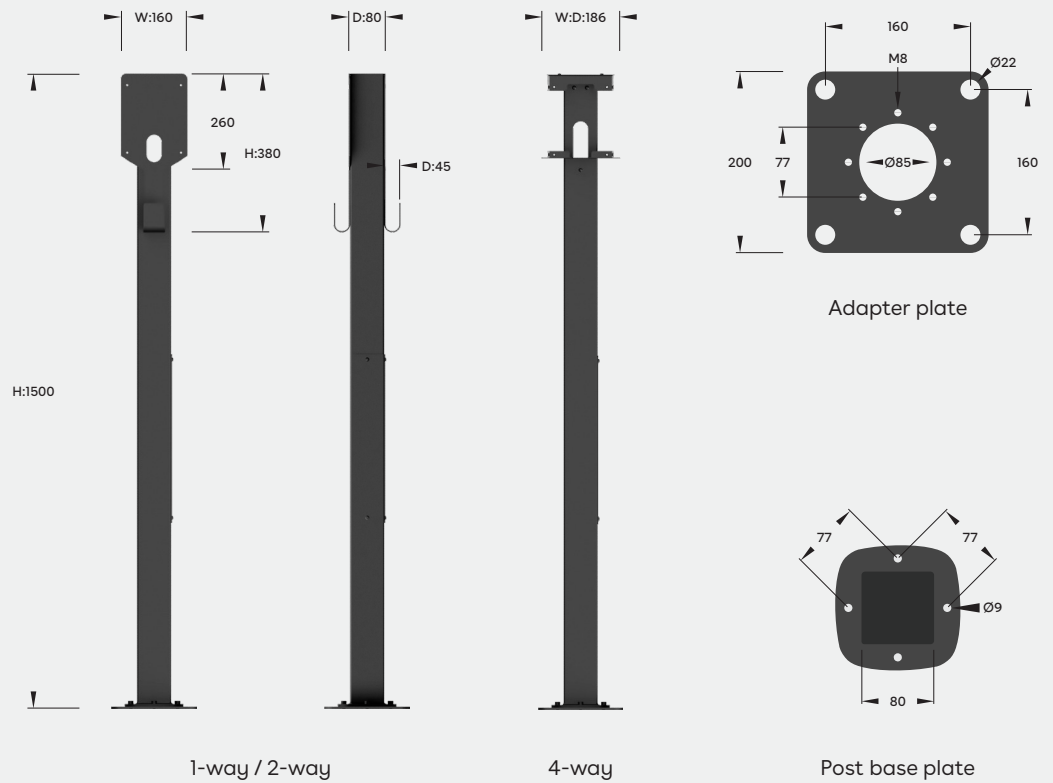

Technical

General

Dimension (mm):

1-way / 2-way: H: 1500 x W: 160 x D: 80.

4-way: H: 1500 x W: 186 x D: 186.

Mounting plate (mm):

H: 380 x W: 160 x D: 45.

Weight: 6.1-7.7 kg.

Material: Aluminium and stainless steel
(adapter plate/ mounting plate).

Finish: Powder coating.

Colour: Black.

IP degree: IP44.

Insulation class: I (with Power Rail).

Impact resistance: IK10.

Features

Adapter plate for c/c 160 mm² foundation.

45 degree rotation intervals (using the
adapter plate).

Screws and nuts included.

Adapter plate supports 22 mm bolts.

Electrical connection

Connection via Power Rail (optional) requires
the circuit to be RCD protected.

It's possible to connect multiple charging
posts in series.

Power Rail cable size

Maximum support of 16mm² flexible
conductors with ferrules and 25mm² solid
conductors.

Cable length between Power Rail and
chargers: 135 cm.

Conductor material: CU or ALU.

Common parts

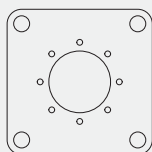

Adapter plate



Power Rail + ground connection plate



Side panel



Column

1-way
Part no. 90322

2-way
Part no. 90323

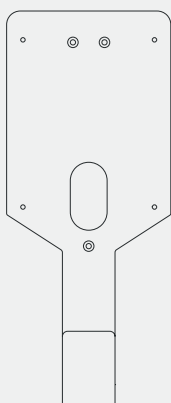

Mounting plate

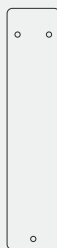

1-way cover

4-Way
Part no. 90324

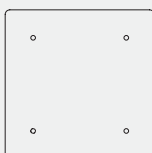

Top plate

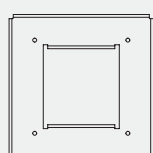

Top frame

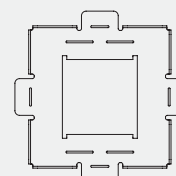

Bottom frame



Multi-way cover
(sold separately)

The information in this document is for information purposes only, is provided as is, and may be subject to change without notice. Easee ASA, including its subsidiaries, does not accept any liability for the correctness or completeness of the information and illustrations, and is not liable or responsible for your considerations, assessments, decisions or absence of such, or other use of the information in this document.

No part of this publication may be re-published, reproduced, transmitted or re-used in any other form, by any means or in any form, for your own or any third-party's use, unless otherwise agreed with Easee or its subsidiaries in writing. Any permitted use shall always be done in accordance with good practice and ensure that no harm may be caused to Easee or by misleading the consumer.

Easee and Easee products, product names, trademarks and slogans, whether registered or not, are Easee's intellectual property and may not be used without Easee's prior written permission. All other products and services mentioned may be trademarks or service marks of their respective owners.

The latest version of this publication can be downloaded at <http://easee.support>

November 2022 - Version 1.03
© 2018 by Easee ASA. All rights reserved.



Easee ASA
Vassbotnen 23
4033 Stavanger, Norway
Org.nr: 920 292 046

Easee is distributed and maintained by a network of qualified partners and resellers. Find more information and your local partner at:

www.easee.com