

Installation Manual

Universal Side-of-Pole Mount

BS090010



Introduction

The Universal Side-of-Pole Mount BS090010 is a simple and straightforward pole mounting solution for small area solar photovoltaic (PV) needs. With its user settable angle adjustment, it can support installations in a wide range of locations.

In addition, Our BS090010 can custom-made according customer solar panel size. It can suit 1pcs or 2pcs or more solar panels in lie alongside

The pole diameters from 2.0 inches to 4.5-inches.

1. Installer Responsibility

The installer is solely responsible for:

- ◆Complying with all applicable local or national building codes, including any that may supersede this manual
- ◆Ensuring that BrightSolar and other products are appropriate for the particular installation and the installation environment
- ◆Ensuring that the selected mount can support the array under live load conditions
- ◆Using only BrightSolar parts and installer-supplied parts as specified by Bright Solar. Substitution parts may void the warranty
- ◆Ensuring safe installation of all electrical aspects of the PV array.

2. Customer Support

Bright Solar makes every effort to ensure your mounting kit is easy to install. If you need assistance at any point with your installation or have suggestions on how we can improve your experience, call Bright Solar customer support: 86-512-82190750, or email to sales@brightsolar-power.com



3. Tools Required For Assembly



The following tools are required to assemble the Universal Side-of-Pole Mount:

Tool	Used for
Wrenches	◆5/16”cap-end screws
Open-end wrench, Box-end wrench, or 3/8” or greater socket drive with sockets to support the following size hex heads: 5/16”	◆5/16” bolts ◆Cap-end screws on hose clamps
Screwdriver	Cap-end screws on hose clamps

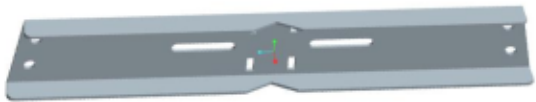
4. Component List

The Universal Side-of-Pole Mount BS09008 kit contains the following parts:

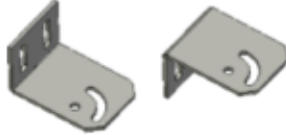
Bucket x2 Attaches to the pole with the hose clamps, providing the link between the pole and the module/rail assembly 	Hose Clamps x4 Attach to the pole, holding the Bucket. These hose clamps are compatible with poles ranging from 2.0 inches to 4.5 inches 
--	--

<p>Rail supports x4 Attach directly to the back of the module</p> 	<p>Clips left x2 and right x2</p> 
<p>Support Rails x2 supporting the lower edge of the panel</p> 	

Part (not included solar panel mounting screws)	Qty
M6X20 hex-cap bolt,SS	24
M6X20 flat washer, SS	24
M6X20 split lock washer, SS	24
M6X20 hex nut, SS	24

5. Assembly

Step 1 – measuring the distance between mounting holes on the PV module

1. Lay the PV Module face down on a protected flat surface
2. Measure the distance between the inside mounting holes on the back of the PV module as shown and make a note of it.

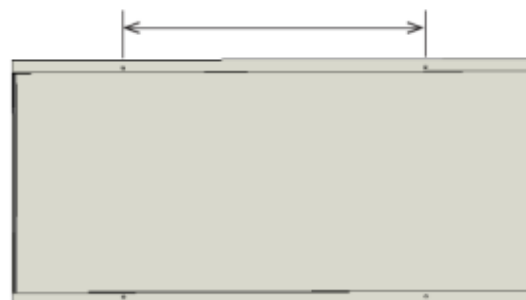

Step 2 – mounting the rail supports on the PV module

Secure the rails with bolt, lock washer, and hex nut in each of the 4 mounting holes.

Tighten the bolts to 7 ft-lbs.

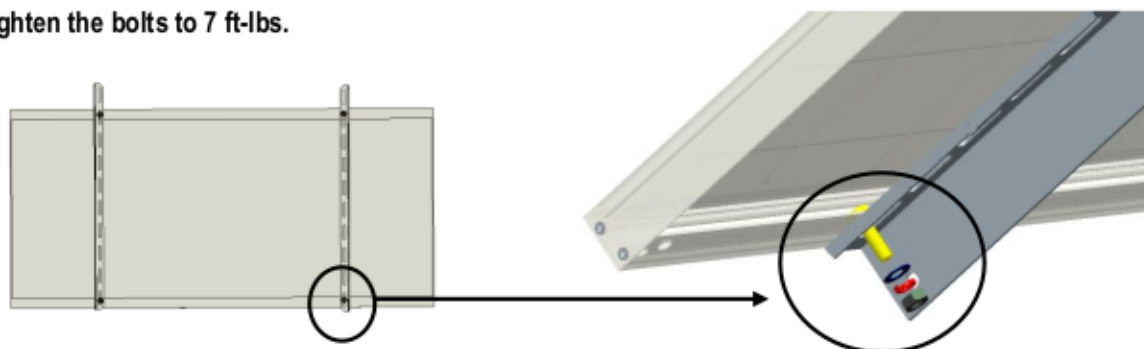

Step 3 – attaching the clips to the rails

Attach the clips to the rails. In each of the mounting holes, use provided bolt and flat washer on one side, and a flat washer, lock washer and nut on the other. Tighten to hold in place.

TIPS: protruding end of the clips can facing the outside edges of the module, or facing the center of the module, depend on distance between the PV module mounting holes

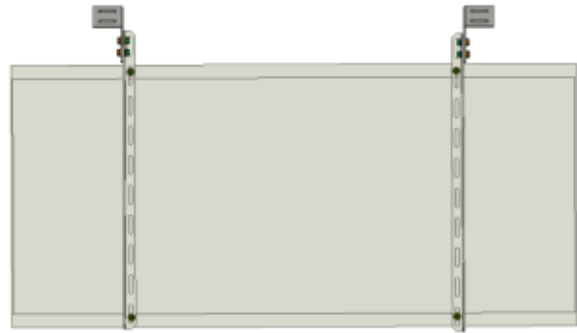

Step 4 – attaching the bucket to the pole

- ◆ Thread each hose clamp through one of the sets of narrow center holes in the bucket as shown and place at the desired location on the pole.
- ◆ Tighten the hose clamp screws

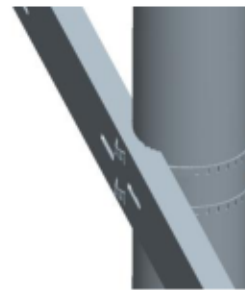

Step 5 – Mounting the PV assembly on the pole

Place the PV module assembly so the holes on the clips line up with holes in the inside of the bucket.

- ◆ Connecting the rails and clips with 1 bolt
- ◆ Connecting the bucket and clips with 1 bolt
- ◆ Lock washer and hex nut each

Note: depending on the size of the panel you started with, your assembly may look different than this picture, with the clips and rails facing in the opposite direction.

Attach the clips to the bucket. In each of the 4 mounting holes, use a 5/16 - 18 x 1" bolt and flat washer on one side, and a washer, lock washer and nut on the other. Tighten the bolts to 12 ft-lbs.

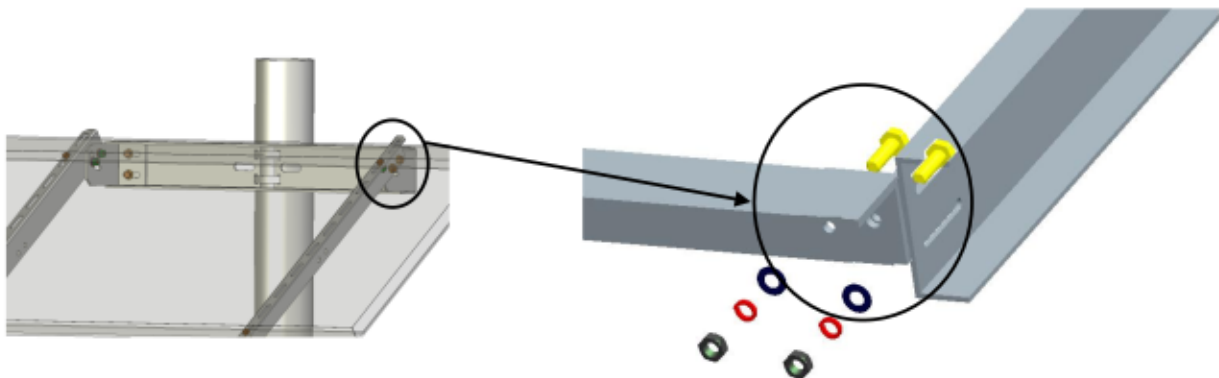

Step 6 – attaching the support rails

Bolt the remaining two clips to the lower bucket using flat washers with a lock washer under the nut.

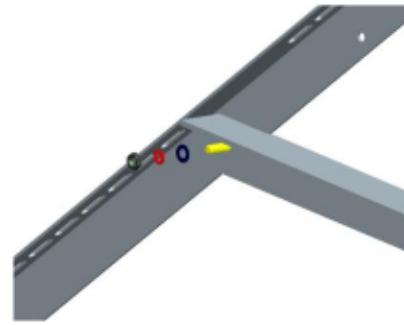

Step 7 – Final Adjustment and Torque of Hardware

Confirm alignment of bucket and knee brace assembly, ensuring knee brace assembly is horizontal and perpendicular to pole.

Tighten all hardware per specifications listed in the table above.

